

2

1

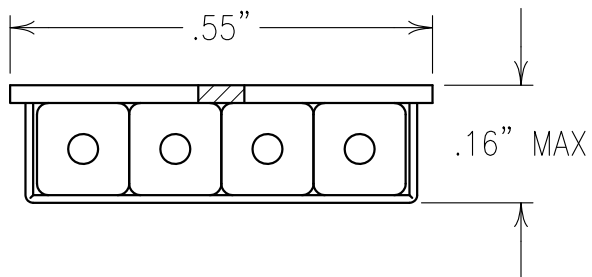

COPY

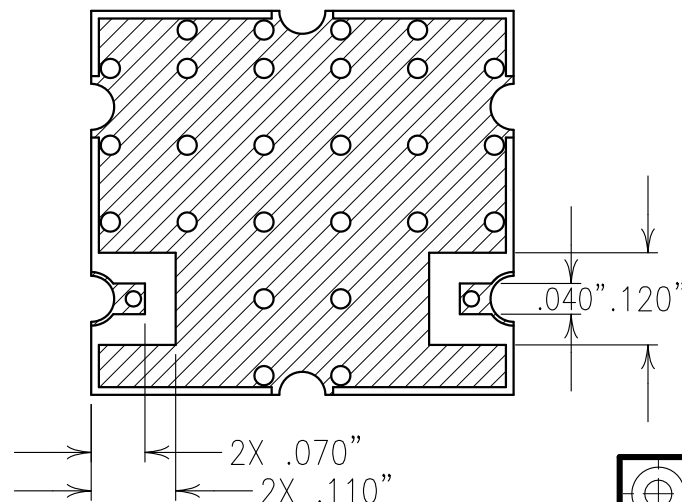
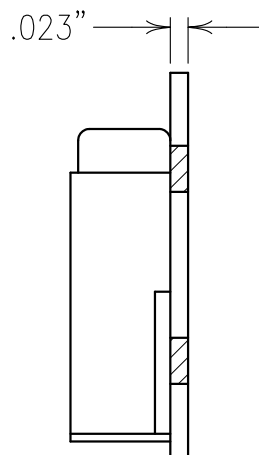
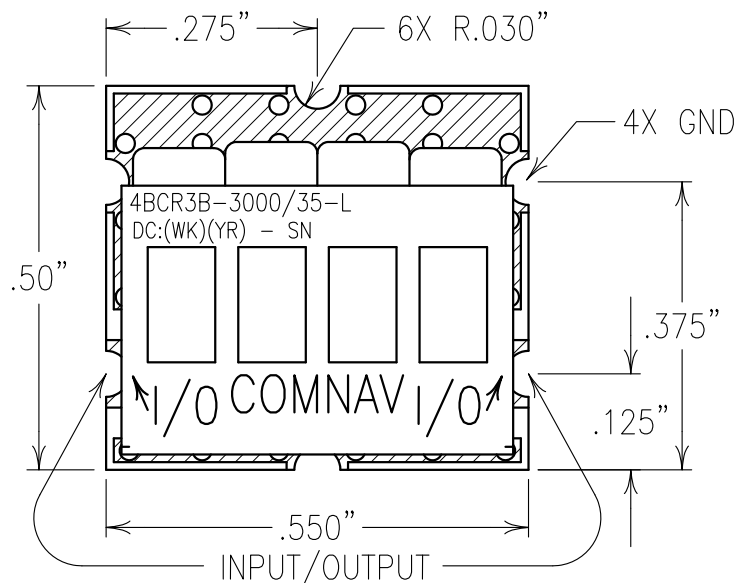

## ELECTRICAL CHARACTERISTICS

CENTER FREQUENCY: 3000 MHz NOM  
 INSERTION LOSS: 4.5 dB MAX @ F0  
 5 dB MAX @ HOT  
 3 dB BANDWIDTH: 35 MHz MIN  
 VSWR: 1.5:1 TYP  
 REJECTION:  
 50 dBc MIN @ 2900 & 3100 MHz  
 80\* dBc MIN @ 2700 & 3300 MHz  
 OPERATING TEMP.: -40 TO +85°C

\* DESIGNED TO MEET 80 dBc, BUT  
 DUE TO GROUNDING WE CAN ONLY  
 GUARANTEE 65 dBc.

Confidential and Proprietary information of ComNav Engineering Inc. Do Not Duplicate or Use Without Permission. ComNav Engineering Inc. claims Copyright in this document as of the Creation, last revision, and last updated dates. All Rights Reserved.

NOTES:  
 RECOMMENDED FOOTPRINT: FP0118.

FILTER MAY BE LABELED OR ETCHED.  
 FILTER IS ROHS COMPLIANT.

ENGLISH / METRIC  
 ENGLISH

TOLERANCES UNLESS  
 OTHERWISE SPECIFIED  
 MACHINED SURFACES  
 TO BE 125 / OR BETTER  
 REMOVE ALL BURRS

ENGLISH (INCHES)  
 .XX ±.02  
 .XXX ±.010  
 ANGLES ± 0° 30'



CHECKED BY

DRAWN BY

ENGINEER

SCALE

DATE

FINISH:

PBF

KJR

4:1

13OCT16

BOARD: NI/GOLD  
 JACKET: NI/SILVER  
 RESONATOR: SILVER

II

REV

APPLIC:

TITLE:

DRAWING No.

13OCT16

KJR

DEV.

BY

DCN No.

INI. ISS. PER 4063

REMARKS

CERAMIC COAXIAL FILTER

4BCR3B-3000/35-L

SHEET OF

1

1

1

1

1

1

1

1

1

1

1

1

1

1

1

1

1

1

1

1

1

1

1

1

1

1

1

1

1

1

1

1

1

1

1

1

1

1

1

1

1

1

1

1

1

1

1

1

1

1

1

1

1

1

1

1

1

1

1

1

1

1

1

1

1

1

1

1

1

1

1

1

1

1

1

1

1

1

1

1

1

1

1

1

1

1

1

1

1

1

1

1

1

1

1

1

1

1

1

1

1

1

1

1

1

1

1

1

1

1

1

1

1

1

1

1

1

1

1

1

1

1

1

1

1

1

1

1

1

1

1

1

1

1

1

1

1

1

1

1

1

1

1

1

1

1

1

1

1

1

1

1

1

1

1

1

1

1

1

1

1

1

1

1

1

1

1

1

1

1

1

1

1

1

1

1

1

1

1

1

1

1

1

1

1

1

1

1

1

1

1

1

1

1

1

1

1

1

1

1

1

1

1

1

1

1

1

1

1

1

1

1

1

1

1

1

1

1

1

1

1

1

1

1

1

1

1

1

1

1

1

1

1

1

1

1

1

1

1

1

1

1

1

1

1

1

1

1

1

1

1

1

1

1

1

1

1

1

1

1

1

1

1

1

1

1

1

1

1

1

1

1

1

1

1

1

1

1

1

1

1

1

1

1

1

1

1

1

1

1

1

1

1

1

1

1

1

1

1

1

1

1

1

1

1

1

1

1

1

1

1

1

1

1

1

1

1

1

1

1

1

1

1

1

1

1

1

1

1

1

1