

**COPY**

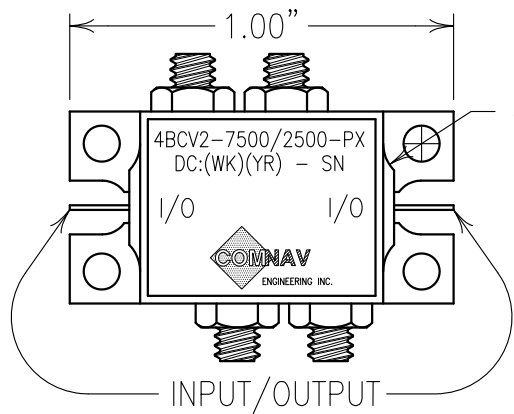
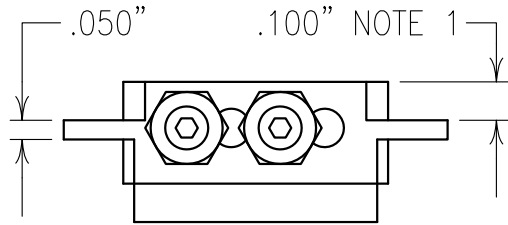

**ELECTRICAL CHARACTERISTICS**

CENTER FREQUENCY: 7500 MHz TYP  
 LOWER 1/2 dBc CORNER: 6500 MHz  
 UPPER 1/2 dBc CORNER: 8500 MHz  
 REJECTION:  
 30 dBc MIN @ DC-1000 MHz  
 15 dBc MIN @ 3-5 GHz  
 5 dBc MIN @ 9-11 GHz  
 15 dBc MIN @ 13-17 GHz  
 25 dBc MIN @ 19.5-25.5 GHz\*  
 40 dBc MIN @ 11.5 GHz  
 25 dBc MIN @ 17.5 GHz  
 40 dBc MIN @ 21.25 GHz\*  
 40 dBc MIN @ 23.65 GHz\*

PASSBAND RIPPLE: 0.125 dB MAX  
 INSERTION LOSS: 2.0 dB MAX  
 IN/OUT RETURN LOSS: 15 dB MIN  
 GROUP DELAY RIPPLE: 200 pSEC MAX  
 OPERATING TEMP.: -80° TO +85°C  
 NON-OPERATING TEMP.: -40° TO +125°C  
 ALTITUDE: 0 TO 30000 METERS\*  
 VIBRATION: MINIMIZE MICROPHONIC SUSCEPTIBILITY\*

\* DESIGN TO MEET, CANNOT TEST.

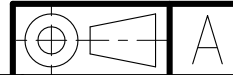
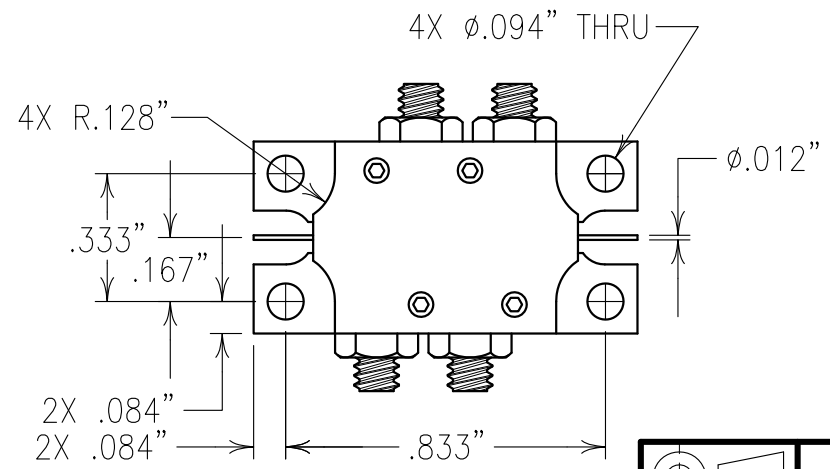
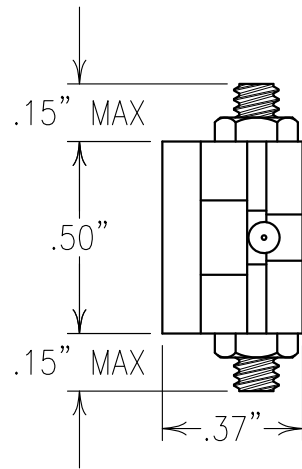

NOTES:  
 1. THE BOTTOM OF PIN IS LEVEL WITH THE BOTTOM OF THE TABS.

FILTER IS ROHS COMPLIANT.  
 FILTER MAY BE LABELED OR ETCHED.

Confidential and Proprietary information of ComNav Engineering Inc. Do Not Duplicate or Use Without Permission. ComNav Engineering Inc. claims Copyright in this document as of the Creation, last revision, and last updated dates. All Rights Reserved.

ENGLISH / METRIC ENGLISH	CHECKED BY B	08FEB17	MJG	DEV.	GEN. REV. PER 4087
TOLERANCES UNLESS OTHERWISE SPECIFIED	DRAWN BY A	25JAN17	MJG	DEV.	GEN. REV. PER 4083
MACHINED SURFACES TO BE 125 OR BETTER	ENGINEER II	26JUL16	MJG	DEV.	INI. ISS. PER 4032
REMOVE ALL BURRS	MJG	REV	DATE	BY	DCN No.
REMARKS					
ENGLISH (INCHES) .XX ±.02 .XXX ±.010	METRIC (MM) .X ±.25 .XX ±.13	SCALE 2:1	APPLIC: INTER-DIGITAL FILTER		
ANGLES ± 0° 30'	DATE 08FEB17	TITLE: 4BCV2-7500/2500-PX			
MATERIAL: ALUMINUM	DRAWING No. 0L1584		SHEET OF 1 1		
FINISH: SILVER OVER COPPER WITH TARNA-BAN MILSPEC QQ-S-365B					