

2

1

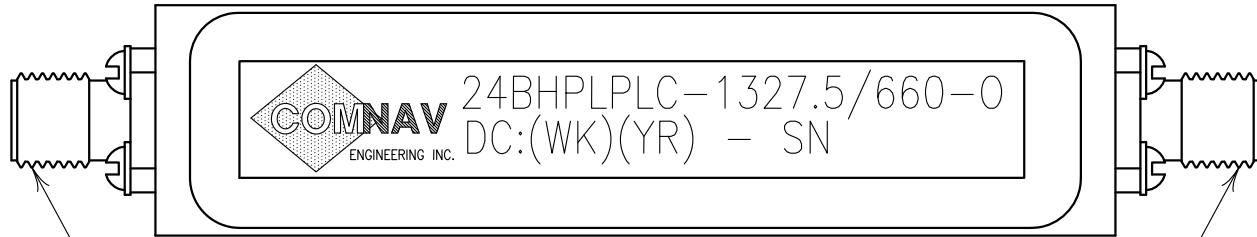

ELECTRICAL CHARACTERISTICS	
CENTER FREQUENCY:	1327.5 MHz NOM
P.B. INSERTION LOSS:	3.0 dB MAX
P.B. BANDWIDTH:	600 MHz MIN
RETURN LOSS:	15 dB
REJECTION:	
	60 dBc MIN @ 885 MHz
	60 dBc MIN @ 1770 MHz
POWER HANDLING:	1 WATT
OPERATING TEMP.:	-20 TO +50°C

INPUT/OUTPUT

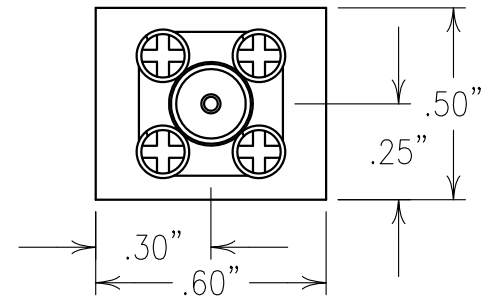
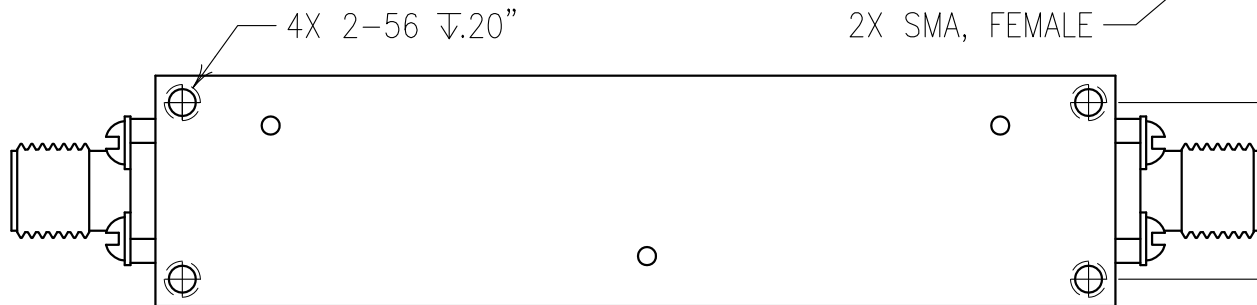
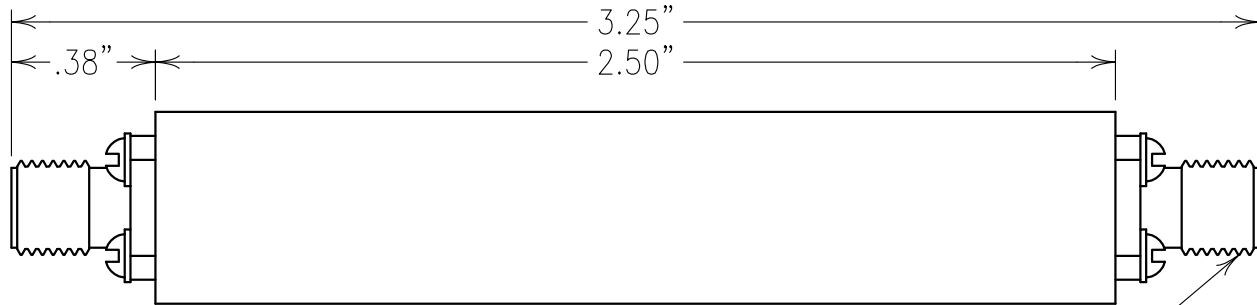

COPY

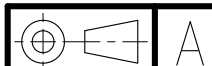
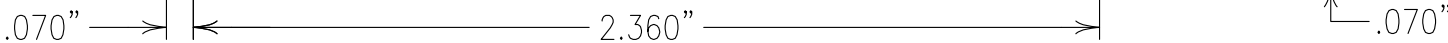

NOTES:

FILTER MAY BE ETCHED OR LABELED.
 FILTER IS ROHS COMPLIANT.

ENGLISH / METRIC ENGLISH	CHECKED BY				
TOLERANCES UNLESS OTHERWISE SPECIFIED MACHINED SURFACES TO BE 125/100 OR BETTER REMOVE ALL BURRS	DRAWN BY PBF				
	ENGINEER KJR	II	04MAR15	KJR	DEV. INI. ISS. PER 3894
		REV	DATE	BY	DCN No. REMARKS
ENGLISH (INCHES) .XX ±.02 .XXX ±.010	METRIC (MM) .X ±.5 .XX ±.25	SCALE 2:1	APPLIC: L/C FILTER		
ANGLES ± 0° 30'	DATE 05MAR15	TITLE: 24BHPLPLC-1327.5/660-0	SHEET OF 1 1		
	MATERIAL: BASE: ALUMINUM/LID: NICKEL/SILVER	DRAWING No.			
	FINISH: BASE: BRIGHT SILVER OVER COPPER WITH TARNA-BAN MILSPEC QQ-S-365D LID: NONE	0L1489			

Confidential and Proprietary information of ComNav Engineering Inc. Do Not Duplicate or Use Without Permission. ComNav Engineering Inc. claims Copyright in this document as of the Creation, last revision, and last updated dates. All Rights Reserved.

