

ELECTRICAL CHARACTERISTICS

CENTER FREQUENCY: 780.5 MHz
 PASSBAND: 758-803 MHz
 3 dB BANDWIDTH: 54 MHz NOM
 P.B. INSERTION LOSS: 2.5 dB MAX
 PASSBAND VSWR: 1.7:1 MAX
 REJECTION:
 25 dB MIN @ 703-748 MHz
 RF INPUT POWER: 10 WATTS MAX
 IMPEDANCE: 50 OHMS IN/OUT
 OPERATING TEMP.: -40 TO +85°C

COPY

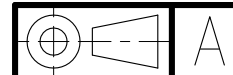

Confidential and Proprietary information of ComNav Engineering Inc. Do Not Duplicate or Use Without Permission. ComNav Engineering Inc. claims Copyright in this document as of the Creation, last revision, and last updated dates. All Rights Reserved.

ENGLISH / METRIC	CHECKED BY				
ENGLISH					
TOLERANCES UNLESS OTHERWISE SPECIFIED MACHINED SURFACES TO BE 125 / OR BETTER REMOVE ALL BURRS	DRAWN BY				
	PBF	II	22JAN15	KJR	DEV. INI. ISS. PER 3880
	ENGINEER	REV	DATE	BY	DCN No.
	KJR				REMARKS

NOTES:

FILTER IS ROHS COMPLIANT.
 FILTER MAY BE LABELED OR ETCHED.

ENGLISH (INCHES)	METRIC (MM)	SCALE	APPLIC:
.XX ±.02	.X ±.50	2:1	CERAMIC COAXIAL FILTER
.XXX ±.010	.XX ±.25	DATE	TITLE:
ANGLES ± 0° 30'		22JAN15	5BCR6E-780.5/C54-L
FINISH: BOARD: NICKEL/GOLD JACKET: NICKEL/SILVER		DRAWING No.	SHEET OF
		0L1484	1 1

