

2

1

ELECTRICAL CHARACTERISTICS

CENTER FREQUENCY: 2350 MHz
 3 dB BANDWIDTH: 300 MHz MIN
 INSERTION LOSS: 1 dB MAX @ F₀
 REJECTION:
 20 dBc MIN @ F₀±180 MHz

COPY

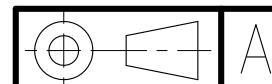
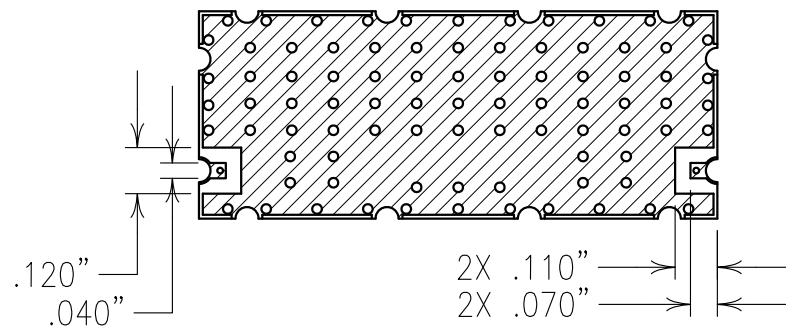
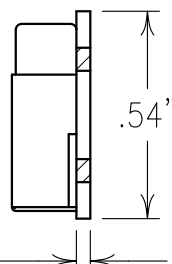
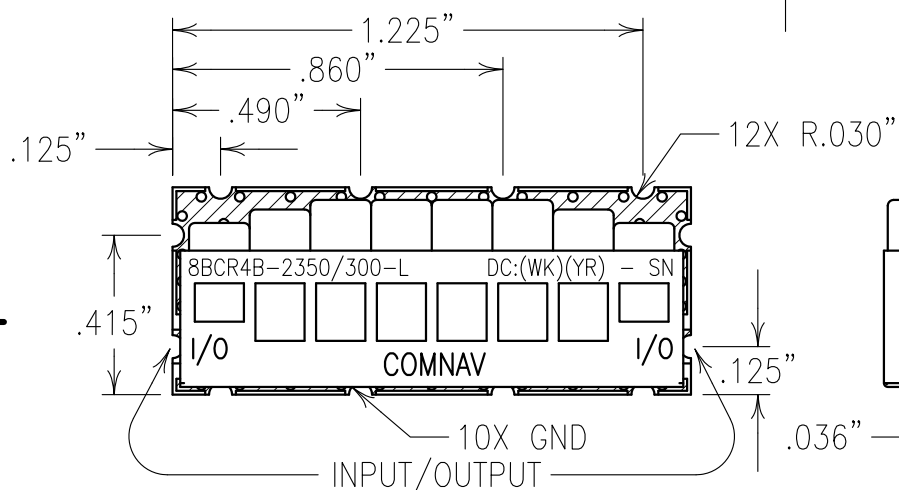
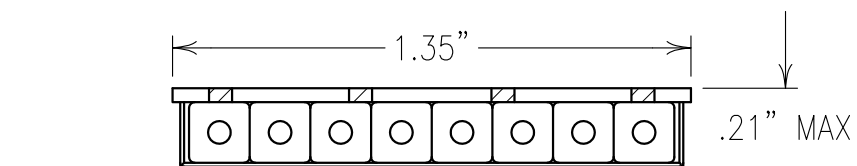

Confidential and Proprietary information of ComNav Engineering Inc. Do Not Duplicate or Use Without Permission. ComNav Engineering Inc. claims Copyright in this document as of the Creation, last revision, and last updated dates. All Rights Reserved.

NOTES: RECOMMENDED ATTACHMENT METHOD:
 SILVER EPOXY OR REFLOW NOT TO EXCEED: TEMP.(°C) MAX. TIME (SECONDS)

215	90
230	60
245	30
260	15

FILTER IS ROHS COMPLIANT.
 FILTER MAY BE LABELED OR ETCHED.

ENGLISH / METRIC ENGLISH	CHECKED BY				
TOLERANCES UNLESS OTHERWISE SPECIFIED MACHINED SURFACES TO BE 125 / OR BETTER REMOVE ALL BURRS	DRAWN BY PBF				
ENGLISH (INCHES) .XX ±.02 .XXX ±.01	ENGINEER KJR	II	11JUL12	KJR	DEV. INI. ISS. PER 3559
ANGLES ± 0° 30'	SCALE 2:1	REV	DATE	BY	DCN No. REMARKS
METRIC (MM) .X ±.25 .XX ±.13	DATE 13JUL12				
COMNAV ENGINEERING, INC.	FINISH: BOARD: NI/AU JACKET: NI/SILVER RESONATOR: SILVER				
	DRAWING No. 0L1315				
					SHEET/OF 1 1