

2

1

COPY

ELECTRICAL CHARACTERISTICS

CENTER FREQUENCY:	1450 MHz
0.5 dB PASSBAND:	1400-1500 MHz
INSERTION LOSS:	1.0 dB MAX
ATTENUATION:	
1100-1220 MHz:	40 dBc MIN
MAX. GROUP DELAY VARIATION	
BETWEEN 1410-1490 MHz:	5 nSEC MAX
OPERATING TEMPERATURE:	-40 TO +70°C

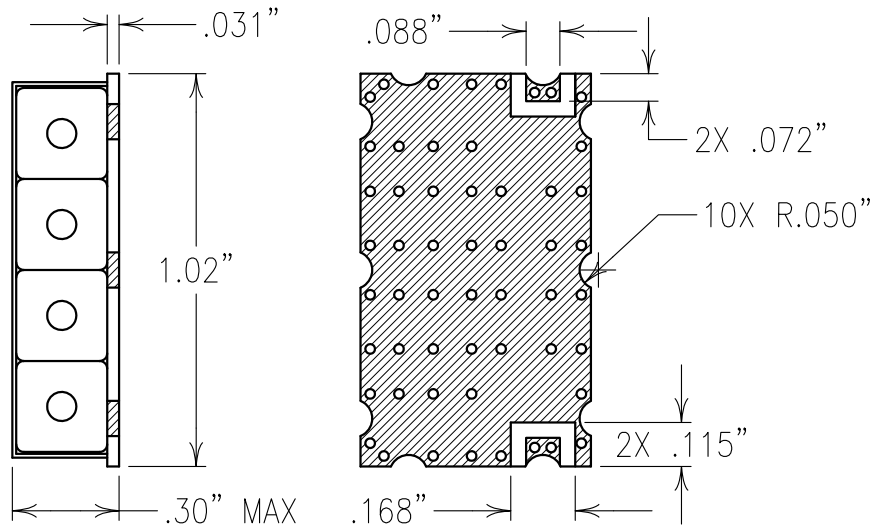
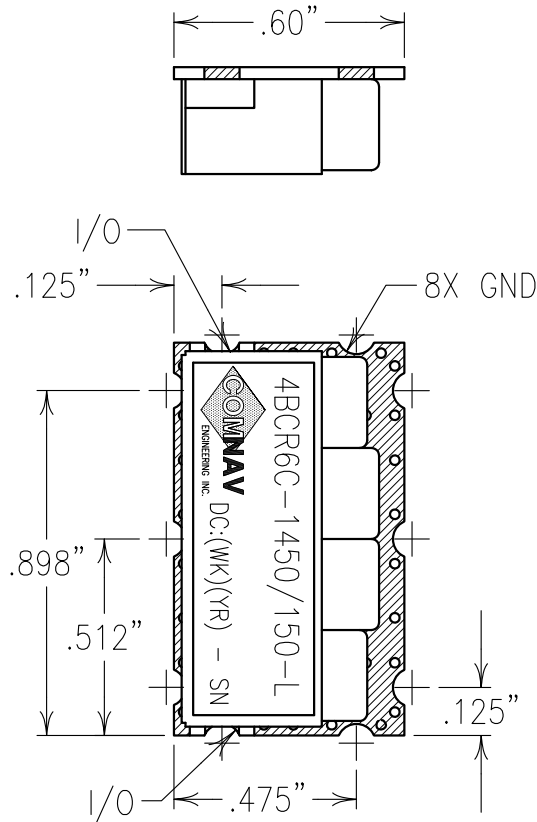

NOTES: FOR RECOMMENDED FOOTPRINT SEE FP0037.  
 RECOMMENDED ATTACHMENT METHOD: SILVER EPOXY  
 OR REFLOW NOT TO EXCEED AS INDICATED BELOW:  
 TEMP.(°C) MAX.TIME(SEC)

215	90	
230	60	
245	30	FILTER IS ROHS COMPLIANT.
260	15	FILTER MAY BE LABELED OR ETCHED.

Confidential and Proprietary information of ComNav Engineering Inc. Do Not Duplicate or Use Without Permission. ComNav Engineering Inc. claims Copyright in this document as of the Creation, last revision, and last updated dates. All Rights Reserved.

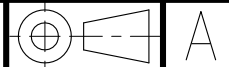

ENGLISH / METRIC ENGLISH	CHECKED BY				
TOLERANCES UNLESS OTHERWISE SPECIFIED	DRAWN BY				
MACHINED SURFACES TO BE 125 / OR BETTER	ENGINEER	II	04JAN11	KJR	DEV. INI. ISS. PER 3314
REMOVE ALL BURRS	ENGINEER	KJR	REV	DATE	BY DCN No. REMARKS
ENGLISH (INCHES)	METRIC (MM)	SCALE	APPLIC: CERAMIC COAXIAL FILTER		
.XX ±.02	.X ±.25	2:1	TITLE: 4BCR6C-1450/150-L		
.XXX ±.010	.XX ±.13	DATE	07JAN11		
ANGLES ± 0° 30'	FINISH:	BOARD: NI/AU PLATED COPPER		DRAWING No. OL1172	
	JACKET: NI/SILVER	RESONATOR: SILVER		SHEET OF 1 1	