

ELECTRICAL CHARACTERISTICS

CENTER FREQUENCY: 100 MHz NOM
 0.5 dB BANDWIDTH: 5.4 MHz MIN
 3 dB BANDWIDTH: 8.8 MHz MAX
 PASSBAND RIPPLE: 0.5 dB
 INSERTION LOSS: 5.25 dB MAX @ FO
 FO ± 2.75 MHz GROUP DELAY VARIATION:
 8 nSEC MAX, 7 nSEC GOAL
 REJECTION:
 15 dBc MIN @ FO ± 15 MHz
 25 dBc MIN @ FO ± 25 MHz
 OPERATING TEMP.: -40 TO +85°C

NOTES:
 RECOMMENDED ATTACHMENT METHOD:
 SILVER EPOXY OR REFLOW NOT TO EXCEED AS INDICATED BELOW:

TEMP.(°C)	MAX.TIME(SEC)
215	90
230	60
245	30
260	15

FILTER IS ROHS COMPLIANT.
 FILTER MAY BE LABELED OR ETCHED.
 FILTER IS NOT BI-DIRECTIONAL.

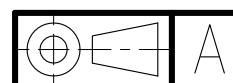

Confidential and Proprietary information of ComNav Engineering Inc. Do Not Duplicate or Use Without Permission. ComNav Engineering Inc. claims Copyright in this document as of the Creation, last revision, and last updated dates. All Rights Reserved.

ENGLISH / METRIC CHECKED BY						
ENGLISH						
TOLERANCES UNLESS OTHERWISE SPECIFIED MACHINED SURFACES TO BE 125 OR BETTER REMOVE ALL BURRS	DRAWN BY	A	17JAN11	KJR	DEV.	GEN. REV. PER 3322
	ENGINEER	II	14OCT10	KJR	DEV.	INI. ISS. PER 3274
	KJR	REV	DATE	BY	DCN No.	REMARKS

ENGLISH (INCHES)	METRIC (MM)	SCALE	APPLIC:
.XX ±.02	.X ±.50	2:1	CHIP AND WIRE FILTER
.XXX ±.010	.XX ±.25	DATE	TITLE:
ANGLES ± 0° 30'		20JAN11	3BLCD-100/8.5-L

FINISH: BOARD: NICKEL/GOLD
 JACKET: NICKEL/SILVER

DRAWING No. 0L1150

SHEET OF 1 1