

COPY

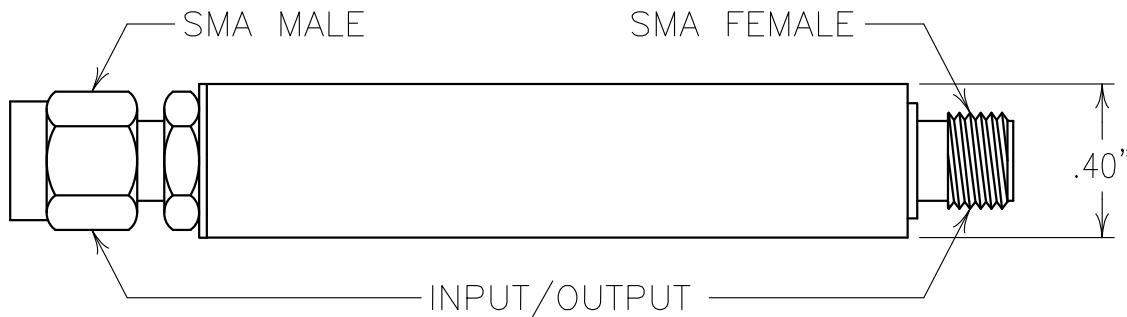

ELECTRICAL CHARACTERISTICS

CENTER FREQUENCY: 170 MHz
 10.0 dB BANDWIDTH: 50.0 MHz MIN
 INSERTION LOSS: 1.5 dB MAX @ FO
 VSWR: 1.5:1 MAX @ 151-189 MHz
 STOPBAND REJECTION:
 60 dBc MIN @ 121.28 MHz
 60 dBc MIN @ 256.28 MHz
 INPUT POWER: AVERAGE 2 WATT MAX/
 PEAK 20 WATT MAX
 OPERATING TEMP.: -40 TO + 85°C
 IMPEDANCE: 50 OHMS IN/OUT
 GROUP DELAY VARIATION:
 2.3 nSEC MAX @ 165-175 MHz
 50 nSEC MAX @ 145-195 MHz

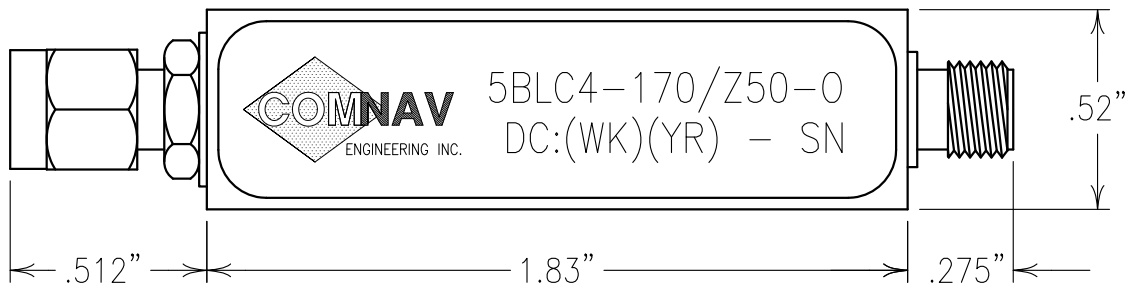
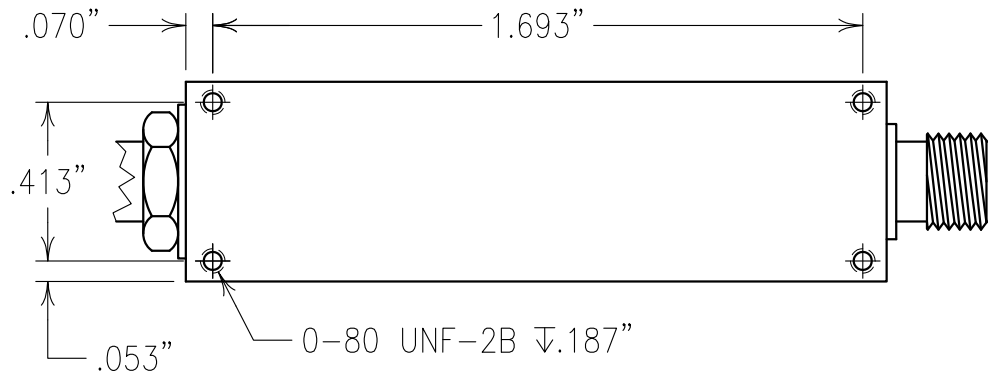
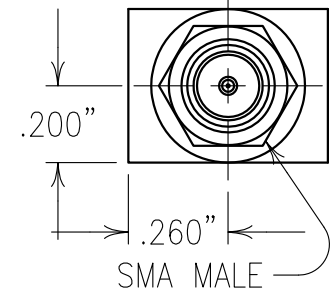
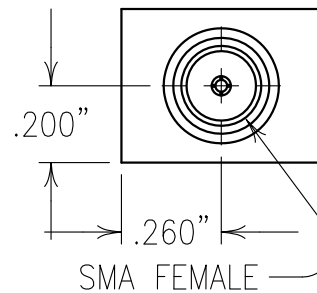

NOTES:
 FILTER IS ROHS COMPLIANT.

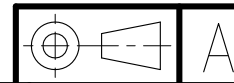

ENGLISH / METRIC ENGLISH	CHECKED BY				
TOLERANCES UNLESS OTHERWISE SPECIFIED	DRAWN BY PBF				
MACHINED SURFACES TO BE 125 OR BETTER REMOVE ALL BURRS	ENGINEER KJR	II	06OCT10	KJR	DEV. INI. ISS. PER 3270
		REV	DATE	BY	DCN No. REMARKS

ENGLISH (INCHES) .XX ±.02 .XXX ±.01	METRIC (MM) .X ±.4 .XX ±.25	SCALE 2:1	APPLIC: LC FILTER	TITLE: 5BLC4-170/Z50-0	SHEET OF 1 1
ANGLES ± 0° 30'		DATE 15OCT10			

MATERIAL: LID: NICKEL/SILVER BASE: ALUMINUM 6061-T6	DRAWING No. OL1142
FINISH: LID: NONE BASE: SILVER MATTE OVER COPPER WITH TARNA-BAN MILSPEC QQS-365	

Confidential and Proprietary information of ComNav Engineering Inc. Do Not Duplicate or Use Without Permission. ComNav Engineering Inc. claims Copyright in this document as of the Creation, last revision, and last updated dates. All Rights Reserved.

