

ELECTRICAL CHARACTERISTICS	
CENTER FREQUENCY:	1000 MHz
PASSBAND:	750-1250 MHz
LOSS @ F0:	<1.25
PASSBAND FLATNESS:	<1.75 dB
PASSBAND VSWR:	<1.7:1
40 dBc REJECTION:	DC->675, 1325->2500 MHz
60 dBc REJECTION:	2500-5000 MHz
OPERATING TEMP.:	-55° TO +90°C

COPY

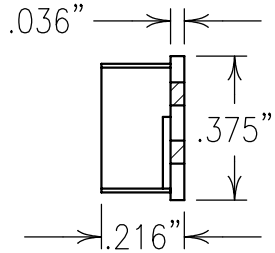
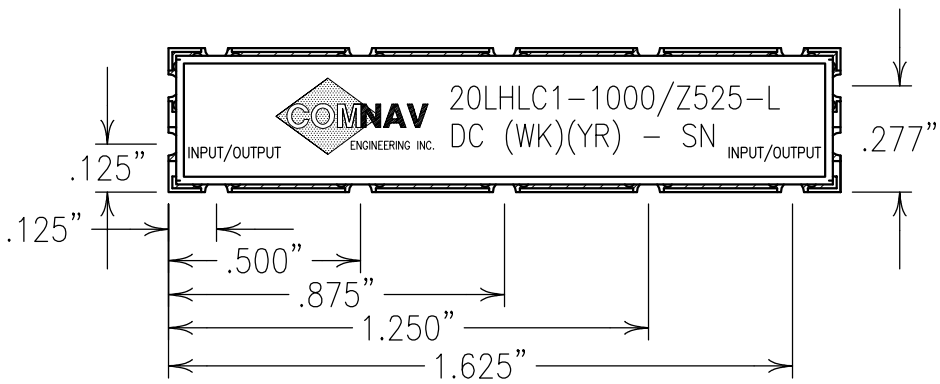

Confidential and Proprietary information of ComNav Engineering Inc. Do Not Duplicate or Use Without Permission. ComNav Engineering Inc. claims Copyright in this document as of the Creation, last revision, and last updated dates. All Rights Reserved.

NOTES:

RECOMMENDED ATTACHMENT METHOD:
SILVER EPOXY OR REFLOW NOT TO EXCEED AS INDICATED BELOW:

TEMP.(°C)	MAX.TIME(SEC)
215	90
230	60
245	30
260	15

FILTER IS ROHS COMPLIANT.
FILTER MAY BE LABELED OR ETCHED.

ENGLISH / METRIC ENGLISH	CHECKED BY				
TOLERANCES UNLESS OTHERWISE SPECIFIED	DRAWN BY				
MACHINED SURFACES TO BE 125/100 OR BETTER	PBF	II	22JUL09	KJR	DEV.
REMOVE ALL BURRS	ENGINEER	REV	DATE	BY	DCN No.
	KJR				REMARKS
ENGLISH (INCHES)	METRIC (MM)	SCALE	APPLIC: CHIP AND WIRE COAXIAL FILTER		
.XX ±.02	.X ±.50	2:1	TITLE: 20LHLC1-1000/Z525-L		
.XXX ±.010	.XX ±.25	DATE			
ANGLES ± 0° 30'	22JUL09				
COMNAV ENGINEERING INC.	FINISH: BOARD: NICKEL/GOLD	DRAWING No.		SHEET OF	
	JACKET: NICKEL/SILVER	OL1025		1 1	