

2

1

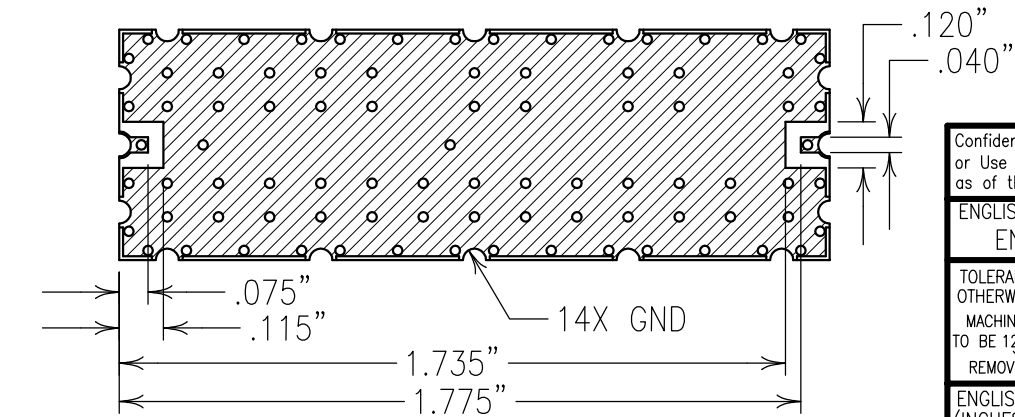
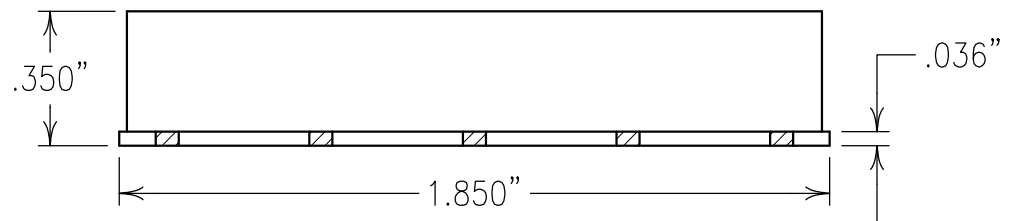
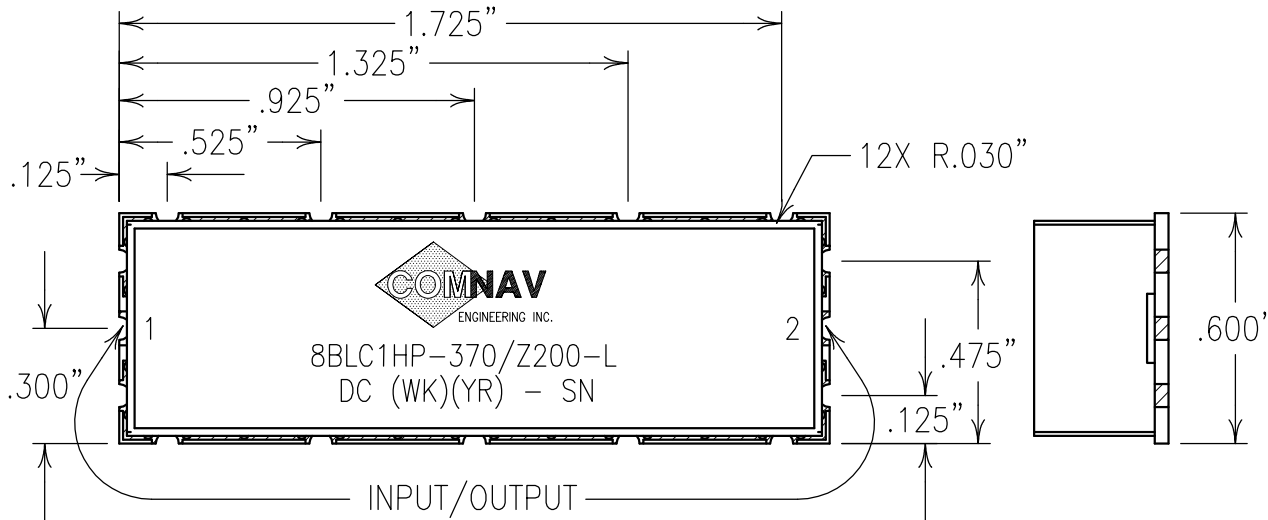

COPY

ELECTRICAL CHARACTERISTICS

CENTER FREQUENCY:	370 MHz
PASSBAND:	290-450 MHz
PASSBAND INSERTION LOSS:	0.9 dB MAX
PASSBAND FLATNESS:	0.2 dB MAX
PASSBAND RETURN LOSS:	14 dB MIN
ATTENUATION:	
DC-90 MHz:	80 dBc MIN*
145-225 MHz:	40 dBc MIN
580-800 MHz:	50 dBc MIN
1000-3100 MHz:	60 dBc MIN*
OPERATING TEMP.:	-40 TO +85°C
MAX. POWER HANDLING:	40 WATTS IN PASSBAND INTO 10:1 MISMATCH

*DESIGN TO MEET

NOTES:

NO TIN PLATING UNDER SOLDER MASK.
 RECOMMENDED ATTACHMENT METHOD:
 SILVER EPOXY OR REFLOW NOT TO EXCEED AS INDICATED BELOW:

TEMP.(°C)	MAX.TIME(SEC)
215	90
230	60
245	30
260	15

LABEL MUST BE PLACED WITH THE LOWPASS ON THE LEFT SIDE.
 FILTER IS ROHS COMPLIANT.

Confidential and Proprietary information of ComNav Engineering Inc. Do Not Duplicate or Use Without Permission. ComNav Engineering Inc. claims Copyright in this document as of the Creation, last revision, and last updated dates. All Rights Reserved.

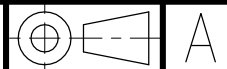

ENGLISH / METRIC ENGLISH	CHECKED BY					
TOLERANCES UNLESS OTHERWISE SPECIFIED MACHINED SURFACES TO BE 125 / OR BETTER REMOVE ALL BURRS	DRAWN BY	A	15SEP08	KJR	DEV.	GEN. REV. PER 2926
	ENGINEER	II	07JUL08	KJR	DEV.	INI. ISS. PER 2905
	REV		DATE	BY	DCN No.	REMARKS

ENGLISH (INCHES)	METRIC (MM)	SCALE	APPLIC:
.XX ±.02	.X ±.25	2:1	LC FILTER
.XXX ±.010	.XX ±.13	DATE	TITLE:
ANGLES ± 0° 30'		15SEP08	8BLC1HP-370/Z200-L

COMNAV ENGINEERING INC.	FINISH:	BOARD: NI/AU PLATED COPPER	DRAWING No.	SHEET OF 1 1
		JACKET: NI/SILVER RESONATOR: SILVER	OL0930	