

COPY

ELECTRICAL CHARACTERISTICS	
CHANNEL 1 PASSBAND:	DC-461 MHz
CHANNEL 1 REJECTION:	
520-3,000 MHz:	50 dBc
CHANNEL 2 PASSBAND:	469-3,000 MHz
CHANNEL 2 REJECTION:	
DC-409 MHz:	50 dBc
CROSSOVER REJECTION (BOTH):	
465±1 MHz:	5 dBc
PASSBAND LOSS (BOTH):	2.5 dB MAX

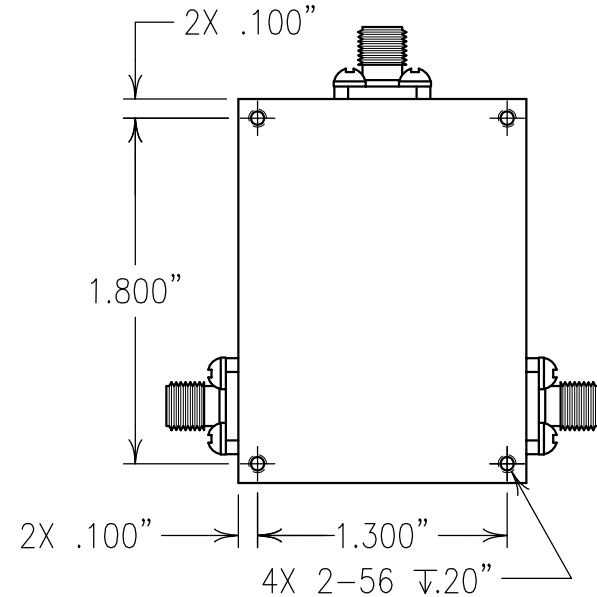
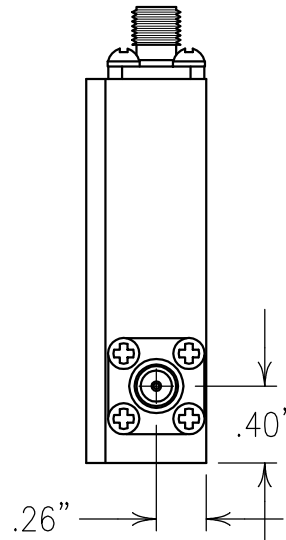
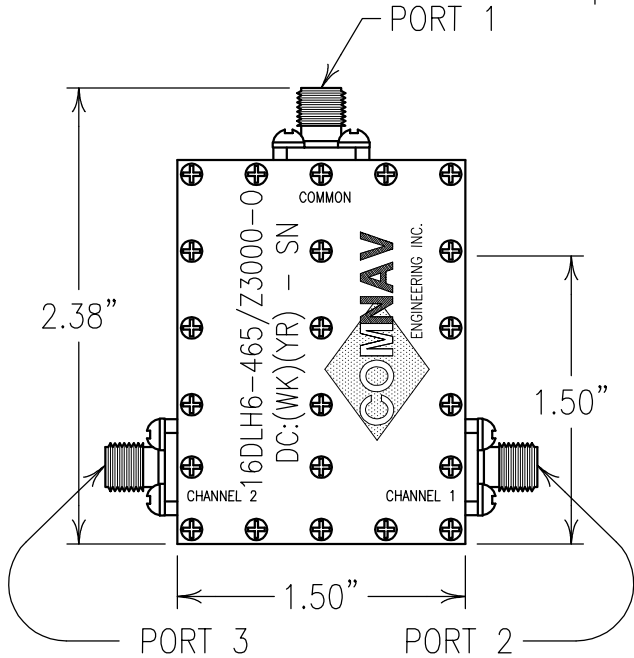

ENGLISH / METRIC ENGLISH	CHECKED BY	B	14SEP09	MJG	DEV.	GEN. REV. PER 3113
TOLERANCES UNLESS OTHERWISE SPECIFIED	DRAWN BY	A	23JUL09	MJG	DEV.	GEN. REV. PER 3093
MACHINED SURFACES TO BE 125 / OR BETTER	ENGINEER	II	03JUL08	KJR	DEV.	INI. ISS. PER 2897
REMOVE ALL BURRS	MJG	REV	DATE	BY	DCN No.	REMARKS
ENGLISH (INCHES)	METRIC (MM)	SCALE 1:1		APPLIC: CHIP AND WIRE FILTER		
.XX ±.01	.X ±.2	DATE 17SEP09		TITLE: 16DLH6-465/Z3000-0		SHEET OF 1 1
.XXX ±.005	.XX ±.13	MATERIAL: ALUMINUM		DRAWING No. 0L0908		
ANGLES ± 0° 30'		FINISH: SILVER				

NOTES:

FILTER MAY BE LABELED OR ETCHED.
FILTER IS ROHS COMPLIANT.

Confidential and Proprietary information of ComNav Engineering Inc. Do Not Duplicate or Use Without Permission. ComNav Engineering Inc. claims Copyright in this document as of the Creation, last revision, and last updated dates. All Rights Reserved.

