

COPY

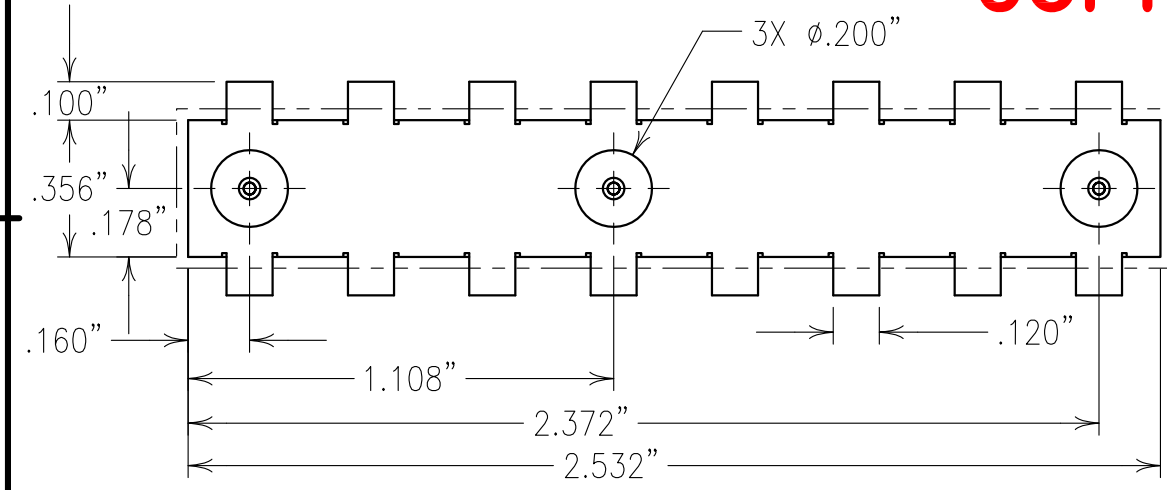

ELECTRICAL CHARACTERISTICS	
RX	TX
CENTER FREQUENCY: 1747.5 MHz	1842.5 MHz
PASSBAND: 1710-1785 MHz	1805-1880 MHz
PASSBAND VSWR: 1.7:1	1.7:1
AT ROOM TEMPERATURE:	
REJECTION: 25 dB MIN: 1805-1880 MHz	
REJECTION: 30 dB MIN: 1710-1785 MHz	
INSERTION LOSS: <2.5 dB	<2.3 dB, 2.0 dB GOAL
OVER OPERATING TEMPERATURE:	
REJECTION: 24 dB MIN: 1805-1880 MHz	
REJECTION: 29 dB MIN: 1710-1785 MHz	
INSERTION LOSS: <3.1 dB	<2.4 dB
TX TO ANTENNA PATH.	
RX INSERTION LOSS AND RX REJECTION APPLY TO THE RX TO ANTENNA PATH.	
POWER HANDLING: THE TX TO ANTENNA MUST WITHSTAND 25 WATTS CW OVER THE TEMPERATURE RANGE OF -20 TO +85°C. THE ANTENNA TO RX PATH MUST WITHSTAND 0 dBm.	
IMPEDANCE: 50 OHMS AT ALL THREE PORTS.	

Confidential and Proprietary information of ComNav Engineering Inc. Do Not Duplicate or Use Without Permission. ComNav Engineering Inc. claims Copyright in this document as of the Creation, last revision, and last updated dates. All Rights Reserved.

- NOTES:
- DC: IS ON ONE SIDE ONLY.
 - DRT P/N 502-00078 IS TO BE ETCHED ON JACKET. FILTER IS ROHS COMPLIANT

ENGLISH / METRIC ENGLISH	CHECKED BY	B	16NOV10	KJR	DEV.	GEN. REV. PER 3286
TOLERANCES UNLESS OTHERWISE SPECIFIED MACHINED SURFACES TO BE 125/ OR BETTER REMOVE ALL BURRS	DRAWN BY	A	30JAN09	KJR	DEV.	GEN. REV. PER 3003
	ENGINEER	II	16MAY08	KJR	DEV.	INI. ISS. PER 2884
		REV	DATE	BY	DCN No.	REMARKS
ENGLISH (INCHES) .XX ±.02 .XXX ±.010	METRIC (MM) .X ±.5 .XX ±.25	SCALE	APPLIC: CERAMIC COAXIAL FILTER			
ANGLES ± 0° 30'	DATE	02MAR11	TITLE: 8DCR8B-1747.5/1842.5/Z-DX			
	FINISH:	PINS: TIN PLATED BRASS JACKET: NI/SILVER RESONATOR: SILVER			DRAWING No.	0L0883

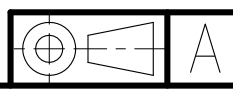

SHEET OF
1 1