

2

1

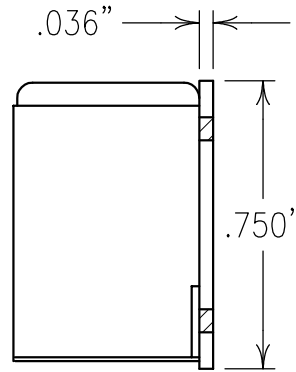
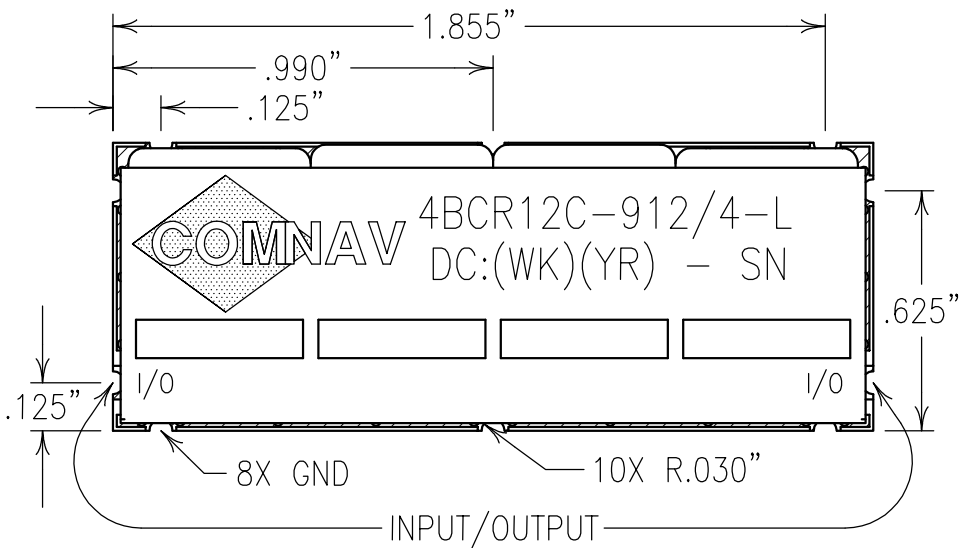

ELECTRICAL CHARACTERISTICS

CENTER FREQUENCY: 912 MHz
 3 dB BANDWIDTH: 5 MHz NOM.
 1.2 dB PASSBAND: 910-914 MHz
 INSERTION LOSS: 5.0 dB MAX @ 912 MHz
 VSWR: 1.5:1 TYP.
 MAX. INPUT POWER: 36 dBm
 REJECTION:
 20 dB MIN @ 906 & 918 MHz
 60 dB MIN @ 946 & 1496 MHz
 OPERATING TEMP.: -40° TO +85° C

B

COPY

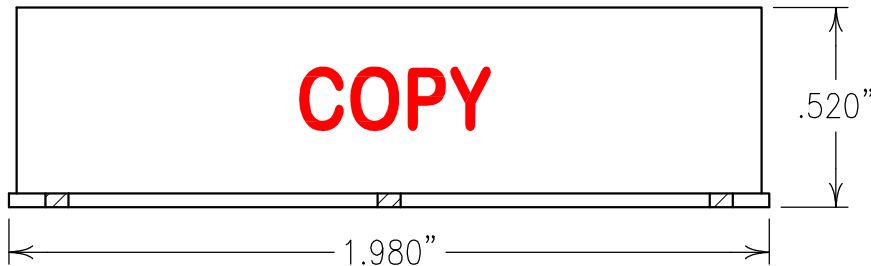

NOTES:

TEMP.(°C)	MAX.TIME (SEC)	
215	90	FILTER MAY BE ETCHED OR LABELED. FILTER IS ROHS COMPLIANT.
230	60	
245	30	
260	15	

RECOMMENDED ATTACHMENT METHOD: SILVER EPOXY OR REFLOW NOT TO EXCEED AS INDICATED ABOVE.

RECOMMENDED FOOTPRINT: FP0096.

Confidential and Proprietary information of ComNav Engineering Inc. Do Not Duplicate or Use Without Permission. ComNav Engineering Inc. claims Copyright in this document as of the Creation, last revision, and last updated dates. All Rights Reserved.

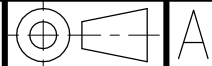

ENGLISH / METRIC ENGLISH	CHECKED BY						
TOLERANCES UNLESS OTHERWISE SPECIFIED MACHINED SURFACES TO BE 125 / OR BETTER REMOVE ALL BURRS	DRAWN BY PBF						
	ENGINEER KJR	II	04DEC07	KJR	DEV.	INI. ISS. PER 2792	
		REV	DATE	BY	DCN No.	REMARKS	
ENGLISH (INCHES) .XX ±.02 .XXX ±.010	METRIC (MM) .X ±.5 .XX ±.25	SCALE 2:1	APPLIC: CERAMIC COAXIAL FILTER				
ANGLES ± 0° 30'	DATE 05DEC07	TITLE: 4BCR12C-912/4-L					
COMNAV ENGINEERING INC		FINISH: BOARD: NI/AU PLATED COPPER JACKET: NI/SILVER RESONATOR: SILVER			DRAWING No. 0L0804		SHEET OF 1 1

A