

2

1

ELECTRICAL CHARACTERISTICS	
CENTER FREQUENCY:	1575.42 MHz
3 dB BANDWIDTH:	17 MHz MIN
INSERTION LOSS:	1.0 dB MAX @ FO
VSWR:	1.5:1 TYPICAL
REJECTION:	
	40 dBc MIN @ 1555 AND 1595 MHz
OPERATING TEMP.:	-55° TO +85°C
MAX. POWER:	10 WATTS

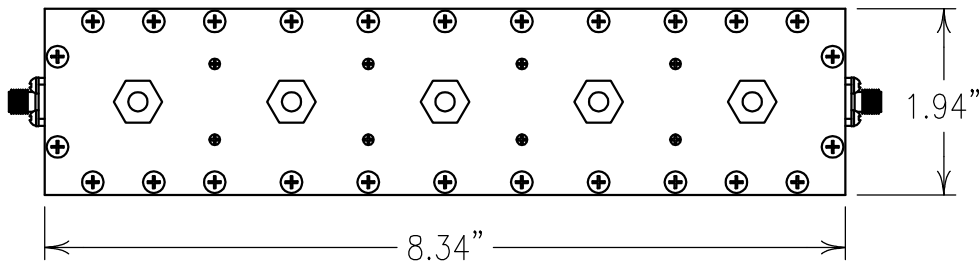

**COPY**

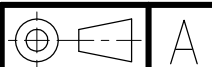
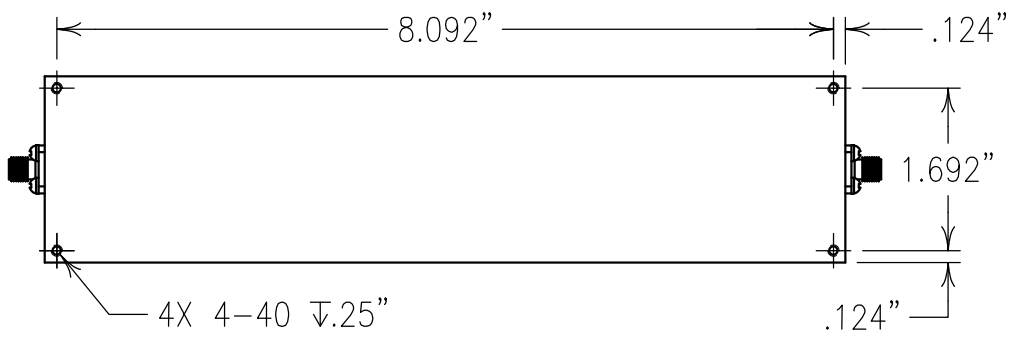
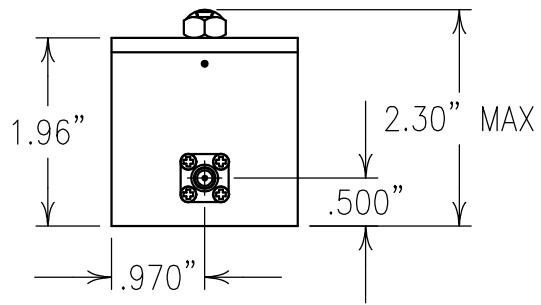
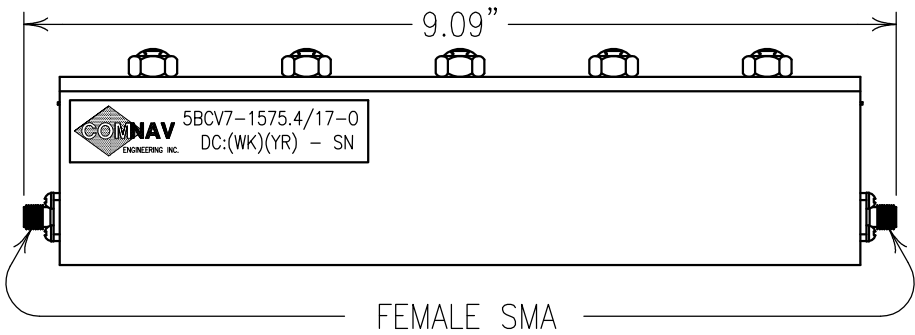

Confidential and Proprietary information of ComNav Engineering Inc. Do Not Duplicate or Use Without Permission. ComNav Engineering Inc. claims Copyright in this document as of the Creation, last revision, and last updated dates. All Rights Reserved.

ENGLISH / METRIC ENGLISH	CHECKED BY				
TOLERANCES UNLESS OTHERWISE SPECIFIED TO BE 125/100 OR BETTER REMOVE ALL BURRS	DRAWN BY PBF	A	04JAN08	KJR	DEV. GEN. REV. PER 2808
	ENGINEER KJR	II	29NOV07	KJR	DEV. INI. ISS. PER 2791
	REV	DATE	BY	DCN No.	REMARKS

ENGLISH (INCHES) .XX ±.01 .XXX ±.005	METRIC (MM) .X ±.2 .XX ±.13	SCALE 1:2	APPLIC: COAXIAL FILTER
ANGLES ± 0° 30'	DATE 27FEB08	TITLE: 5BCV7-1575.4/17-0	SHEET OF 1 1

NOTES:

FILTER IS ROHS COMPLIANT.



MATERIAL: ALUMINUM  
FINISH:  
SILVER OVER COPPER WITH  
TARNA-BAN MILSPEC QQ-S-365B

DRAWING No.  
0L0802