

2

1

ELECTRICAL CHARACTERISTICS

1 dB BANDWIDTH:	700±2 MHz TO 1900±2 MHz
INSERTION LOSS @ FO:	< 4.0 dB MAX
VSWR:	2.0:1 TYP
PHASE LINEARITY:	±11° @ 850-1750 MHz
REJECTION:	15 dBc MIN @ 2000-2100 MHz
	40 dBc MIN @ DC-400 MHz
	40 dBc MIN @ 2200-4200 MHz

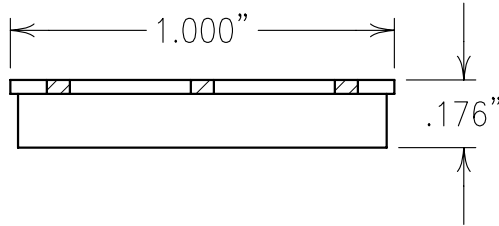

COPY

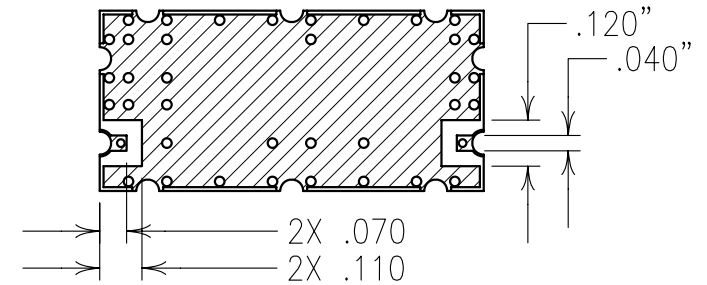
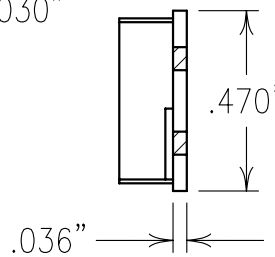
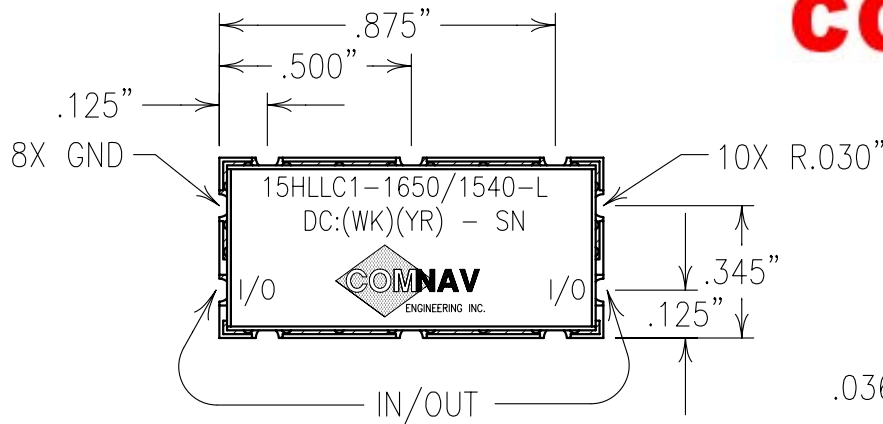

Confidential and Proprietary information of ComNav Engineering Inc. Do Not Duplicate or Use Without Permission. ComNav Engineering Inc. claims Copyright in this document as of the Creation, last revision, and last updated dates. All Rights Reserved.

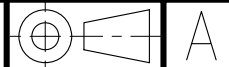

NOTES:

NO TIN PLATING UNDER SOLDER MASK.
 RECOMMENDED ATTACHMENT METHOD: SILVER EPOXY
 OR REFLOW NOT TO EXCEED AS INDICATED BELOW:

TEMP.(°C) MAX.TIME(SEC)

215	90
230	60
245	30
260	15

FILTER IS ROHS COMPLIANT.

ENGLISH / METRIC ENGLISH	CHECKED BY					
TOLERANCES UNLESS OTHERWISE SPECIFIED	DRAWN BY	A	29MAR06	KJR	DEV.	GEN. REV. PER 2508
MACHINED SURFACES TO BE 125/ OR BETTER REMOVE ALL BURRS	ENGINEER	II	23JAN06	KJR	DEV.	INI. ISS. PER 2470
ENGLISH (INCHES)	METRIC (MM)	SCALE	APPLIC: CERAMIC COAXIAL FILTER			
.XX ±.02	.X ±.25	2:1	TITLE: 15HLLC1-1650/1540-L			
.XXX ±.010	.XX ±.13	DATE	29MAR06			
ANGLES ± 0° 30'	FINISH:	BOARD: NI/AU PLATED COPPER			DRAWING No. 0L0621	
	JACKET: NI/SILVER				SHEET OF 1 1	