

2

1

TOP VIEW

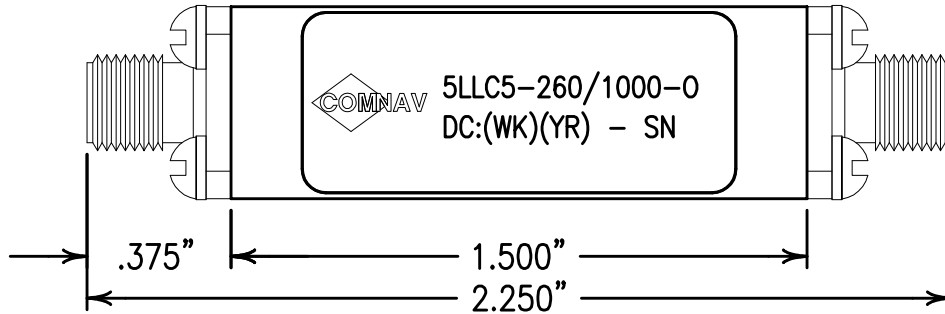

ELECTRICAL CHARACTERISTICS	
3 dB CUTOFF FREQUENCY:	260 MHz NOM
LOSS @ DC-255 MHz:	<1.8 dB
50 dB REJECTION:	275-1000 MHz
VSWR:	1.5:1 TYP.
POWER HANDLING:	> 20 dBm

COPY

BOTTOM VIEW

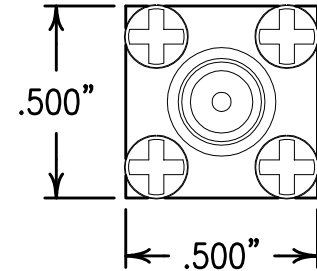
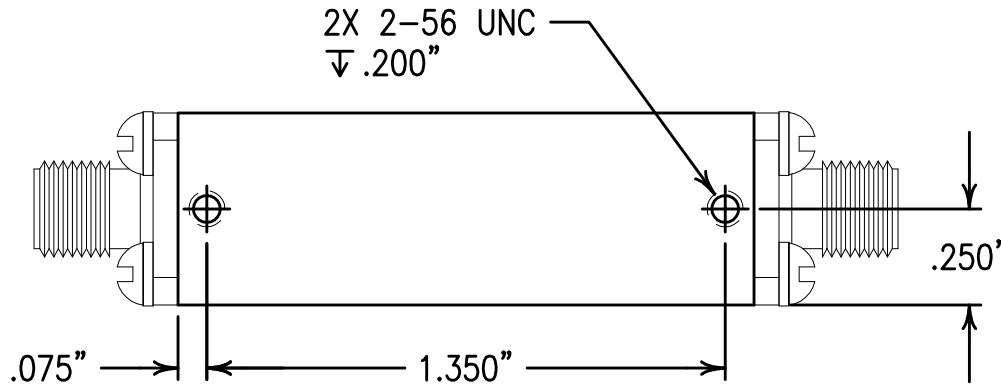

Confidential and Proprietary information of ComNav Engineering Inc. Do Not Duplicate or Use Without Permission. ComNav Engineering Inc. claims Copyright in this document as of the Creation, last revision, and last updated dates. All Rights Reserved.

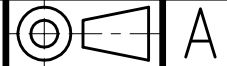

NOTES:

BOTH CONNECTORS ARE SMA.
COMNAV PART# AND DATE CODE ARE ETCHED ON LID.

ENGLISH / METRIC ENGLISH		CHECKED BY					
TOLERANCES UNLESS OTHERWISE SPECIFIED		DRAWN BY		II	01OCT03	MJG	DEV.
MACHINED SURFACES TO BE 125 / OR BETTER		PBF		II	16SEP03	MJG	DEV.
REMOVE ALL BURRS		ENGINEER		REV	DATE	BY	DCN No.
		MJG					REMARKS
ENGLISH (INCHES)	METRIC (MM)	SCALE		APPLIC:			
.XX ±.02	.X ±.25	2:1		CHIP & WIRE FILTER			
.XXX ±.010	.XX ±.13	DATE		TITLE:			
ANGLES ± 0° 30'		06OCT03		5LLC5-260/1000-0			
MATERIAL: N/A		DRAWING No.		SHEET OF			
FINISH: N/A		0L0482		1 1			