

2

1

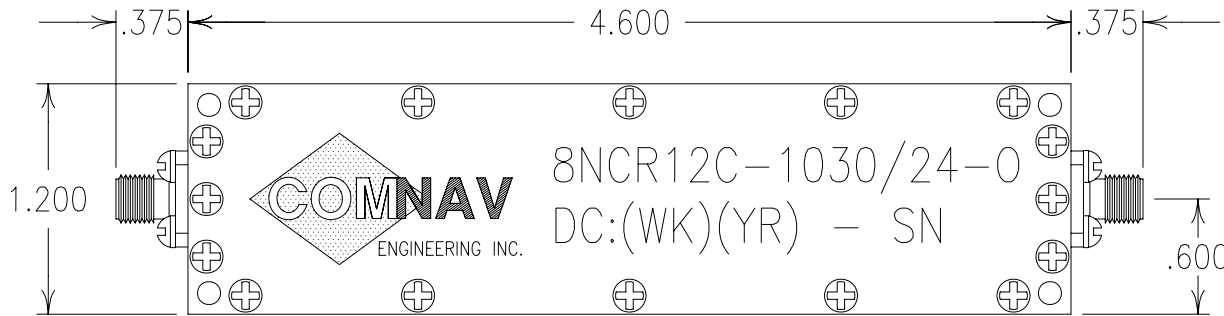

ELECTRICAL CHARACTERISTICS

|                                     |                            |
|-------------------------------------|----------------------------|
| CENTER FREQUENCY:                   | 1030 MHz                   |
| 3 dB BANDWIDTH:                     | 24 MHz NOM                 |
| PASSBAND:                           | 965-1008,<br>1053-1210 MHz |
| PASSBAND LOSS:                      | 1.5 dB MAX                 |
| PASSBAND VSWR:                      | 1.5:1                      |
| PASSBAND DELAY:                     | 26 NSEC MAX                |
| REJECTION:                          |                            |
| 1023-1037 MHz:                      | >50 dBc                    |
| AVE. POWER HANDLING<br>AT 11% DUTY: | 45 WATTS                   |

B

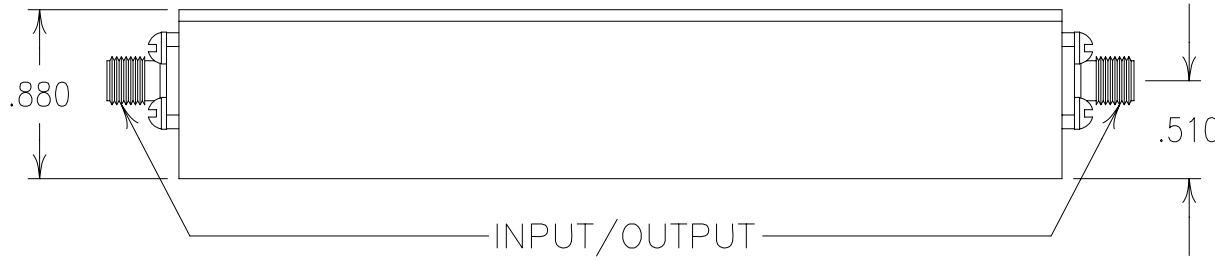

**COPY**

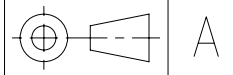
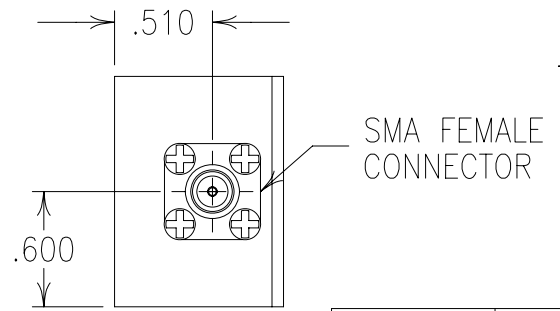
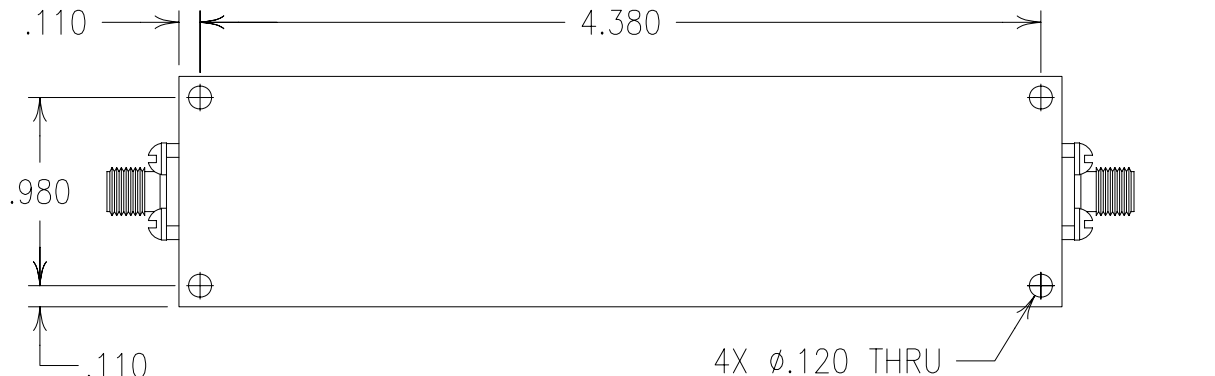

Confidential and Proprietary information of ComNav Engineering Inc. Do Not Duplicate or Use Without Permission. ComNav Engineering Inc. claims Copyright in this document as of the Creation, last revision, and last updated dates. All Rights Reserved.

NOTES:

|  |   |                             |                                |                 |         |                    |
|--|---|-----------------------------|--------------------------------|-----------------|---------|--------------------|
| ENGLISH / METRIC<br>ENGLISH  | CHECKED BY  |                             |                                |                 |         |                    |
| TOLERANCES UNLESS OTHERWISE SPECIFIED<br>MACHINED SURFACES TO BE 125 / OR BETTER<br>REMOVE ALL BURRS | DRAWN BY<br>PBF                                   | A                           | 04AUG03                        | MJG             | DEV.    | GEN. REV. PER 2096 |
|  | ENGINEER<br>MJG                                   | II                          | 06JUN03                        | MJG             | DEV.    | INI. ISS. PER 2083 |
|  |   | REV                         | DATE                           | BY              | DCN No. | REMARKS            |
| ENGLISH (INCHES)<br>.XX ±.01<br>.XXX ±.005   | METRIC (MM)<br>.X ±.2<br>.XX ±.13                 | SCALE<br>1:1                | APPLIC: CERAMIC COAXIAL FILTER |                 |         |                    |
| ANGLES ± 0° 30'  | DATE<br>04AUG03                                   | TITLE:<br>8NCR12C-1030/24-0 |                                |                 |         |                    |
|  | MATERIAL: COVER: ALUMINUM<br>BASE: ALUMINUM       | DRAWING No.<br>OL0469       |                                | SHEET OF<br>1 1 |         |                    |
|  | FINISH: COVER: NICKEL PLATE<br>BASE: NICKEL PLATE |                             |                                |                 |         |                    |

A