

2

1

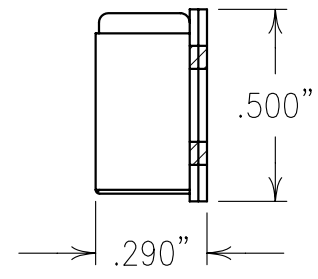

COPY

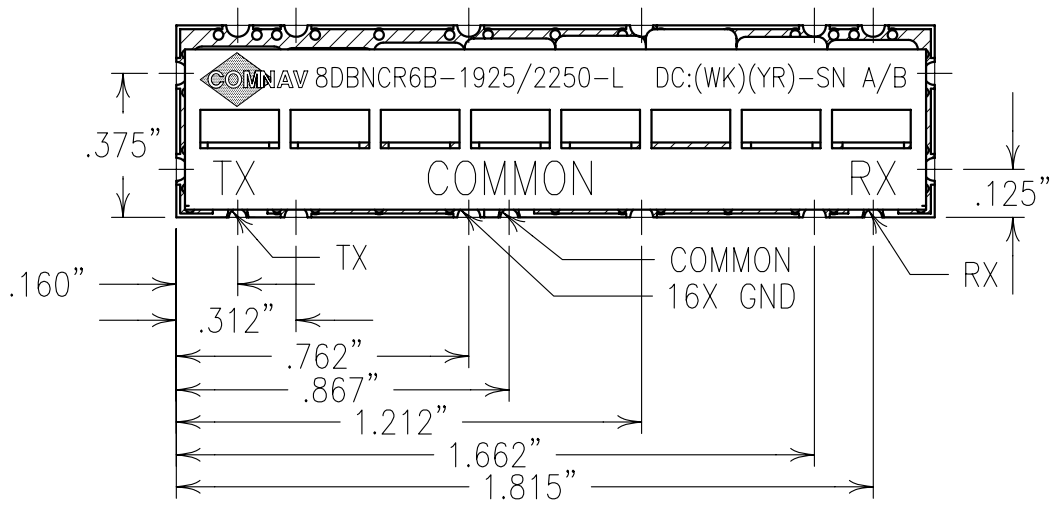
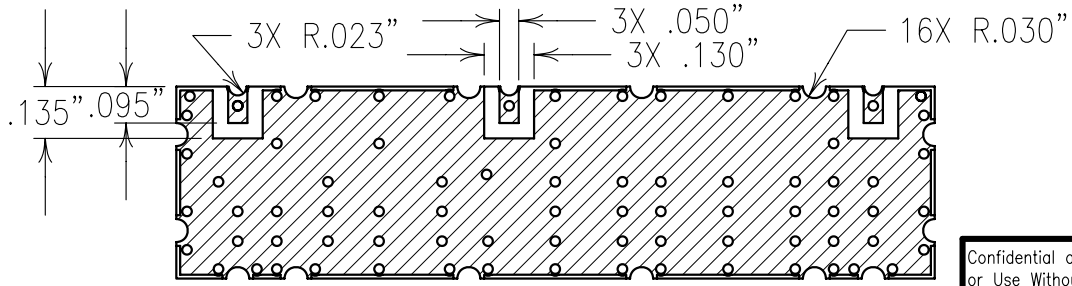
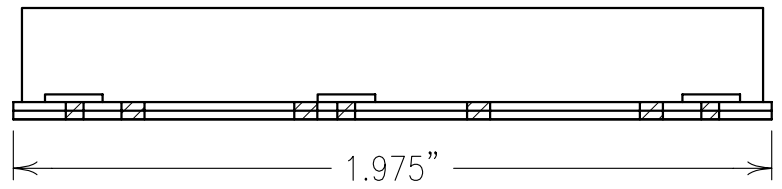

| ELECTRICAL CHARACTERISTICS | | |
|--|-----------|-----------|
| | TX | RX |
| CENTER FREQ.(MHz): | 1925 | 2250 |
| PASSBAND(MHz): | 1750-2100 | 2200-2300 |
| PASSBAND LOSS: | <1.0 dB | <1.1 dB |
| PASSBAND FLATNESS: | <0.5 dB | <0.5 dB |
| PASSBAND VSWR: | 1.5:1 | 1.5:1 |
| REJECTION: | | |
| 25 dBc(MHz): | 2200-2300 | |
| 55 dBc(MHz): | | 1750-2100 |
| BOTH PASSBANDS PHASE MATCHED ±3.5° IN PAIRS. | | |

Confidential and Proprietary information of ComNav Engineering Inc. Do Not Duplicate or Use Without Permission. ComNav Engineering Inc. claims Copyright in this document as of the Creation, last revision, and last updated dates. All Rights Reserved.

NOTES:
 PAIRS ARE DENOTED BY SAME SERIAL NUMBER AND AN A OR B.
 RECOMMENDED ATTACHMENT METHOD:
 SILVER EPOXY OR REFLOW NOT TO EXCEED AS INDICATED:
 TEMP.(°C) MAX.TIME(SEC)

| | |
|-----|----|
| 215 | 90 |
| 230 | 60 |
| 245 | 30 |
| 260 | 15 |

| | | | | | |
|---|-------------|-------------------|-----------------------------|-----|--------------|
| ENGLISH / METRIC ENGLISH | CHECKED BY | | | | |
| TOLERANCES UNLESS OTHERWISE SPECIFIED | DRAWN BY | A | 11SEP03 | MJG | DEV. |
| MACHINED SURFACES TO BE 125 / OR BETTER | PBF | II | 27MAR03 | MJG | DEV. |
| REMOVE ALL BURRS | ENGINEER | REV | DATE | BY | DCN No. |
| | MJG | | | | REMARKS |
| ENGLISH (INCHES) | METRIC (MM) | SCALE | APPLIC: COAXIAL FILTER | | |
| .XX ±.02 | .X ±.25 | 2:1 | TITLE: 8DBNCR6B-1925/2250-L | | |
| .XXX ±.010 | .XX ±.13 | DATE | 11SEP03 | | |
| ANGLES ± 0° 30' | | FINISH: | BOARD: NI/AU PLATED COPPER | | DRAWING No. |
| | | JACKET: NI/SILVER | | | OL0462 |
| | | | | | SHEET OF 1 1 |