

TOP VIEW

SEE DETAIL A

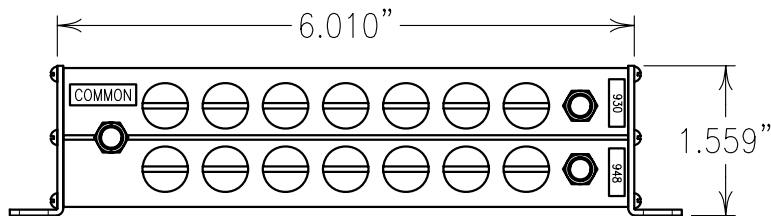

SIDE VIEW

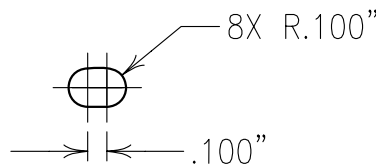

DETAIL A  
SCALE 1:1

**COPY**

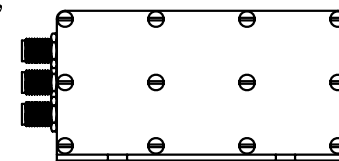

END VIEW

ELECTRICAL CHARACTERISTICS		
	CHANNEL 1	CHANNEL 2
PASSBAND	890-915 MHz	935-960 MHz
PASSBAND LOSS	<1.5 dB	<1.5 dB
PASSBAND FLATNESS	<0.5 dB	<0.5 dB
PASSBAND VSWR	<1.5:1	<1.5:1
RX ATTENUATION:		
DC-800	70 dB	
935-2250	>70 dB	
TX ATTENUATION:		
DC-915		>70 dB
1040-2250		>70 dB

NOTES:

PORTS ARE FEMALE SMA CONNECTORS.

Confidential and Proprietary information of ComNav Engineering Inc. Do Not Duplicate or Use Without Permission. ComNav Engineering Inc. claims Copyright in this document as of the Creation, last revision, and last updated dates. All Rights Reserved.							
ENGLISH / METRIC ENGLISH	CHECKED BY						
TOLERANCES UNLESS OTHERWISE SPECIFIED MACHINED SURFACES TO BE 125 OR BETTER REMOVE ALL BURRS	DRAWN BY	A	18DEC01	SWB	DEV.	GEN. REV. PER 1805	
	ENGINEER	II	12DEC01	SWB	DEV.	INI. ISS. PER 1803	
	REVISIONS	REV	DATE	BY	DCN No.	REMARKS	
ENGLISH (INCHES)	METRIC (MM)	SCALE	APPLIC: CAVITY FILTER				
.XX ±.02 .XXX ±.010	.X ±.25 .XX ±.13	1:2	TITLE: 14DCVEX1-903/948/C30-0				
ANGLES ± 0° 30'		DATE	18DEC01				
		MATERIAL:	N/A			DRAWING No.	SHEET OF
		FINISH:	N/A			0L0381	1 1