

2

1

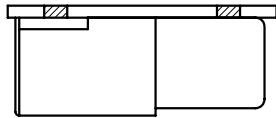

COPY

| ELECTRICAL CHARACTERISTICS | |
|----------------------------|--------------------|
| CENTER FREQUENCY | 1090 MHz |
| 3 dB BANDWIDTH | 28 MHz NOM. |
| PASSBAND | 1087-1093 MHz |
| PASSBAND LOSS | < 1.0 dB |
| PASSBAND FLATNESS | < 0.25 dB |
| VSWR | 1.7:1 TYP. |
| REJECTION: | |
| 32.5 dB | 994 MHz |
| 10 dB | 1060 & 1120 MHz |
| 28 dB | 1186 MHz |
| POWER HANDLING | 10 WATTS W/1% DUTY |
| OPERATING TEMP. | -40° TO +85°C |

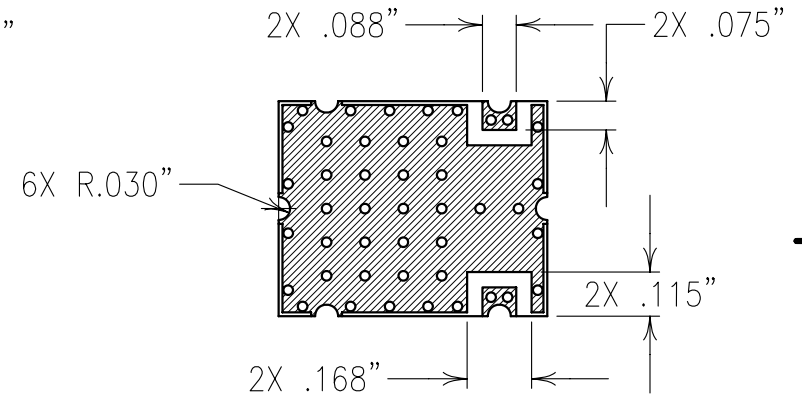
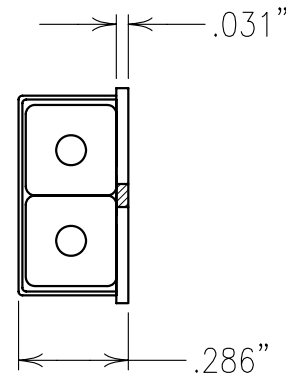
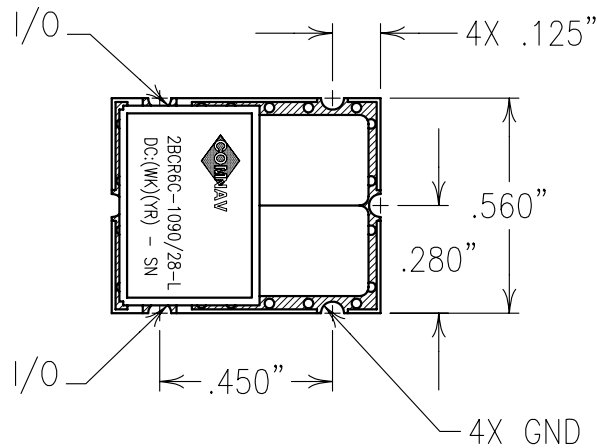

Confidential and Proprietary information of ComNav Engineering Inc. Do Not Duplicate or Use Without Permission. ComNav Engineering Inc. claims Copyright in this document as of the Creation, last revision, and last updated dates. All Rights Reserved.

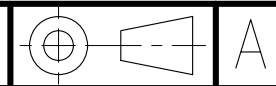

NOTES:

FOR RECOMMENDED FOOTPRINT SEE FP0069.

RECOMMENDED ATTACHMENT METHOD: SILVER EPOXY OR REFLOW NOT TO EXCEED AS INDICATED BELOW:

| TEMP.(°C) | MAX.TIME(SEC) |
|-----------|---------------|
| 215 | 90 |
| 230 | 60 |
| 245 | 30 |
| 260 | 15 |

| ENGLISH / METRIC ENGLISH | | CHECKED BY | | | |
|---|--|------------|--|------------------------|-----------------|
| TOLERANCES UNLESS OTHERWISE SPECIFIED MACHINED SURFACES TO BE 125/ OR BETTER REMOVE ALL BURRS | | DRAWN BY | | | |
| | | RME | | | |
| ENGLISH (INCHES) .XX ±.02 .XXX ±.010 | | ENGINEER | | | |
| | | MJG | | REV | DATE |
| METRIC (MM) .X ±.25 .XX ±.13 | | SCALE | | APPLIC: | |
| | | 2:1 | | CERAMIC COAXIAL FILTER | |
| ANGLES ± 0° 30' | | DATE | | TITLE: | |
| | | 15NOV01 | | 2BCR6C-1090/28-L | |
| FINISH: BOARD: NI/AU JACKET: NI/SILVER RESONATOR: SILVER | | | | DRAWING No. | |
| COMNAV ENGINEERING INC. | | | | 0L0370 | |
| | | | | | SHEET/OF 1/1 |