

2

1

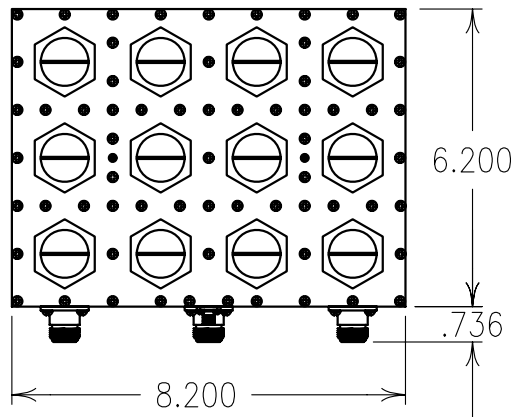

TOP VIEW

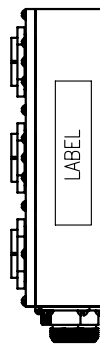

SIDE VIEW

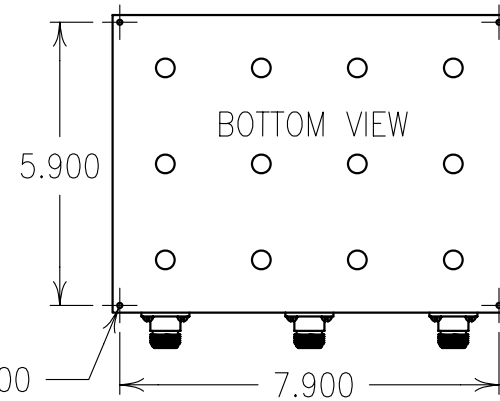

BOTTOM VIEW

**COPY**

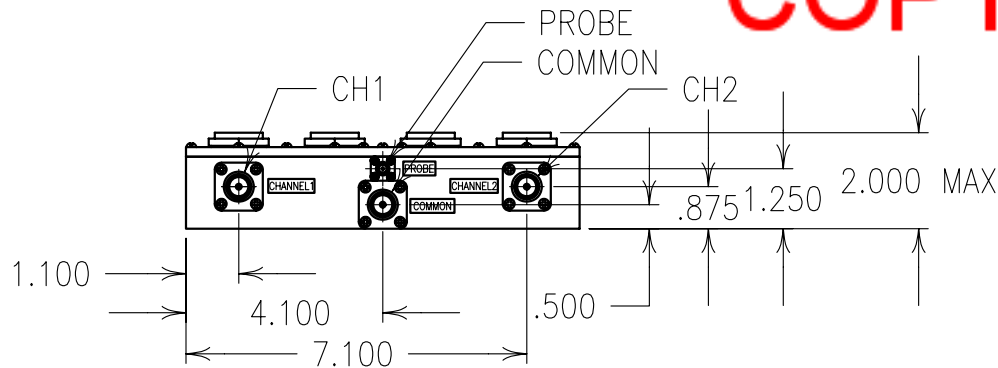

FRONT VIEW

ELECTRICAL CHARACTERISTICS

	CHANNEL1	CHANNEL2
CENTER FREQ.(MHz)	2307.5	2352.5
PASSBAND(MHz)	2305.5-2309.5	2350.5-2354.5
PASSBAND LOSS(dB)	<1.5	<1.5
PASSBAND VARIATION(dB)	<1.0	<1.0
PASSBAND VSWR	<1.5:1	<1.5:1
REJECTION		
DC-2295,2320-2900 MHz(*)	>75 dB	
2295-2300,2315-2320 MHz	>50 dB(**)	
DC-2340,2365-2900 MHz(*)		>75 dB
2340-2345,2360-2365 MHz		>50 dB(**)

(\*) WAVEGUIDE MODES OCCUR AT ~3 GHz.  
 (\*\*) 55 dB GOAL

COUPLER: CAPACITIVE PROBE AT COMMON POINT WILL PROVIDE -30 dB COUPLING IN BOTH PASSBANDS.

Confidential and Proprietary information of ComNav Engineering Inc. Do Not Duplicate or Use Without Permission. ComNav Engineering Inc. claims Copyright in this document as of the Creation, last revision, and last updated dates. All Rights Reserved.

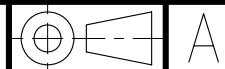

NOTES:

CH1, CH2 AND COMMON ARE ALL N-CONNECTORS. PROBE IS A SMA CONNECTOR.

ON LABEL: 12DCVC-2307.5/2352.5/C6/K-N/O  
 DC (WK/YR) - SN

ENGLISH / METRIC ENGLISH	CHECKED BY					
TOLERANCES UNLESS OTHERWISE SPECIFIED	DRAWN BY	A	14DEC00	KJR	DEV.	GEN. REV. PER 1420
MACHINED SURFACES TO BE 125 OR BETTER REMOVE ALL BURRS	ENGINEER	II	08SEP00	KJR	DEV.	INI. ISS. PER 1311
ENGLISH (INCHES)	METRIC (MM)	SCALE	APPLIC: CAVITY FILTER			
.XX ±.02	.X ±.25	1:4	TITLE: 12DCVC-2307.5/2352.5/C6/K-N/O			
.XXX ±.01	.XX ±.13	DATE	18DEC00			
ANGLES ± 0° 30'		MATERIAL: N/A	DRAWING No.		SHEET OF 1 1	
		FINISH: N/A	0L0281			