

COPY

Confidential and Proprietary information of ComNav Engineering Inc. Do Not Duplicate or Use Without Permission. ComNav Engineering Inc. claims Copyright in this document as of the Creation, last revision, and last updated dates. All Rights Reserved.

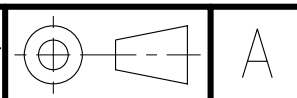

NOTES:

NO TIN PLATING UNDER SOLDER MASK.
RECOMMENDED ATTACHMENT METHOD: SILVER EPOXY OR REFLOW NOT TO EXCEED AS INDICATED BELOW:

TEMP.(°C)	MAX.TIME(SEC)	
215	90	COPPER-NO TIN PLATING
230	60	TIN PLATED COPPER
245	30	SOLDER MASK
260	15	

ENGLISH / METRIC ENGLISH	CHECKED BY				
TOLERANCES UNLESS OTHERWISE SPECIFIED MACHINED SURFACES TO BE 125 OR BETTER REMOVE ALL BURRS	DRAWN BY PBF	II	13DEC99	MJG	DEV.
ENGLISH (INCHES) .XX ±.02 .XXX ±.01	ENGINEER MJG	REV	DATE	BY	DCN No.
METRIC (MM) .X ±.25 .XX ±.13	SCALE 2:1	APPLIC: COAXIAL FILTER			
ANGLES ± 0° 30'	DATE 01FEB00	TITLE: 4BCR6E-1594/50-LX			SHEET NO/OF 1 1
	MATERIAL: N/A	DRAWING No. 0L0218			
	FINISH: N/A				