

COPY

ELECTRICAL CHARACTERISTICS

CENTER FREQUENCY	880 MHz
PASSBAND	867-896 MHz
PASSBAND FLATNESS	0.2 dB OVER ANY 10 MHz
PASSBAND VSWR	<1.5:1
PASSBAND LOSS	<2.0 dB
70 dB REJECTION	DC-760 MHz
IMPEDANCE	50 OHMS
OPERATING TEMP.	-60°C TO +100°C

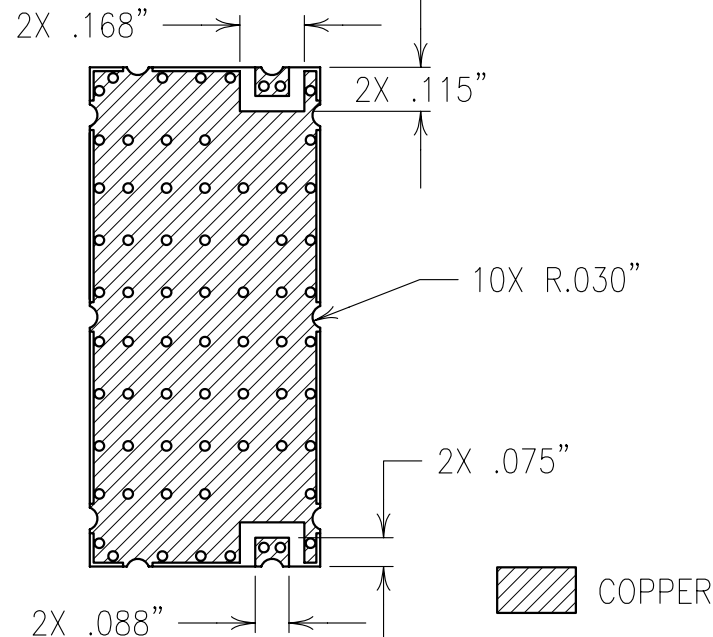
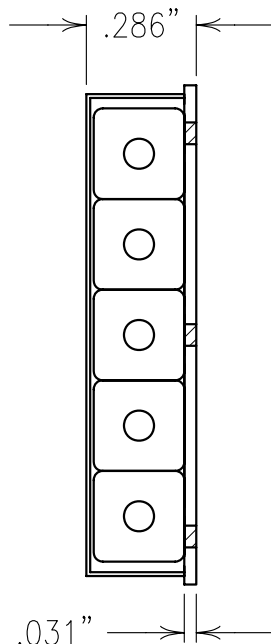
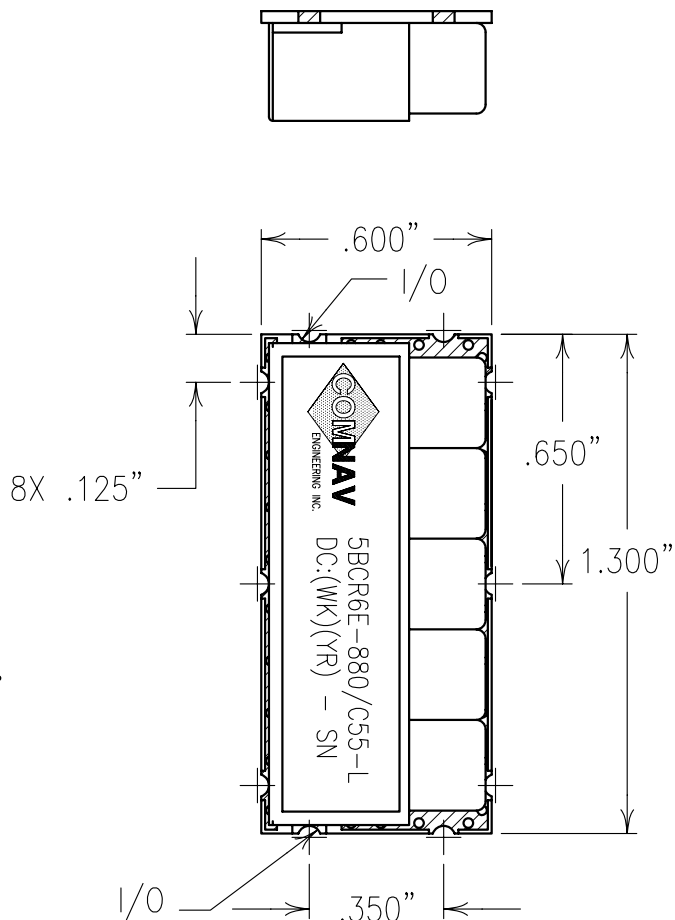

COPPER

Confidential and Proprietary information of ComNav Engineering Inc. Do Not Duplicate or Use Without Permission. ComNav Engineering Inc. claims Copyright in this document as of the Creation, last revision, and last updated dates. All Rights Reserved.

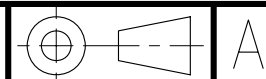

NOTES:

FOR RECOMMENDED FOOTPRINT SEE FP0014.
 RECOMMENDED ATTACHMENT METHOD: SILVER EPOXY
 OR REFLOW NOT TO EXCEED AS INDICATED BELOW:
 TEMP.(°C) MAX.TIME(SEC)

215	90
230	60
245	30
260	15

ENGLISH / METRIC ENGLISH	CHECKED BY						
TOLERANCES UNLESS OTHERWISE SPECIFIED MACHINED SURFACES TO BE 125/ OR BETTER REMOVE ALL BURRS	DRAWN BY	A	01MAY02	RME	DEV.	GEN. REV. PER 1892	
	ENGINEER	II	28DEC98	SWB	DEV.	INI. ISS. PER 0871	
	SCALE	REV	DATE	BY	DCN No.	REMARKS	
ENGLISH (INCHES) .XX ±.02 .XXX ±.01	METRIC (MM) .X ±.25 .XX ±.13	SCALE 2:1	APPLIC: CERAMIC COAXIAL FILTER				
ANGLES ± 0° 30'	DATE 17MAY02	TITLE: 5BCR6E-880/C55-L					
	FINISH: BOARD: NI/AU JACKET: NI/SILVER RESONATOR: SILVER				DRAWING No. 0L0152		SHEET/OF 1/1