

2

1

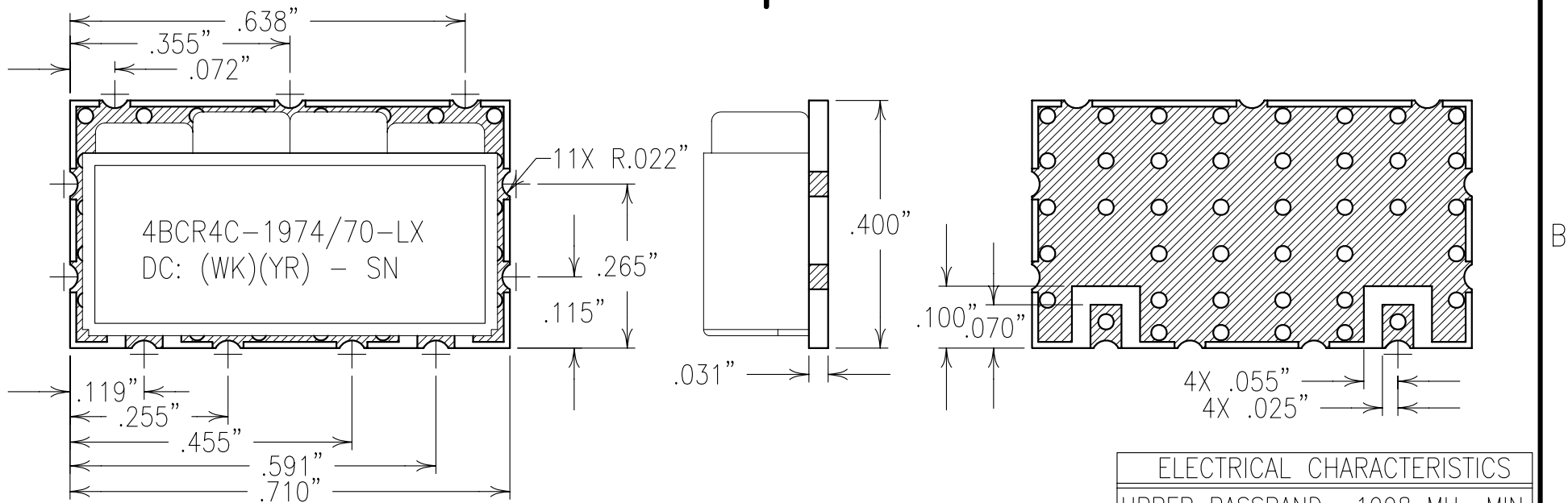

**COPY**

| ELECTRICAL CHARACTERISTICS |                |
|----------------------------|----------------|
| UPPER PASSBAND             | 1998 MHz MIN   |
| LOWER PASSBAND             | 1950 MHz MAX   |
| INSERTION LOSS             |                |
| WITHIN PASSBAND            | 2.5 dB MAX     |
| PASSBAND RIPPLE            | .5 dB P-P      |
| GROUP DELAY                | 5.0 nS P-P MAX |
|                            | OVER PASSBAND  |
| VSWR WITHIN PB             | 1.7:1 MAX      |
| OPERATIONAL TEMP.          | -40 TO +85°C   |

NOTES:

FOR RECOMMENDED FOOTPRINT SEE FP0059.

RECOMMENDED ATTACHMENT METHOD: SILVER EPOXY OR REFLOW NOT TO EXCEED AS INDICATED BELOW:

| TEMP.(°C) | MAX. TIME(SEC) |
|-----------|----------------|
| 215       | 90             |
| 230       | 60             |
| 245       | 30             |
| 260       | 15             |

Confidential and Proprietary information of ComNav Engineering Inc. Do Not Duplicate or Use Without Permission. ComNav Engineering Inc. claims Copyright in this document as of the Creation, last revision, and last updated dates. All Rights Reserved.

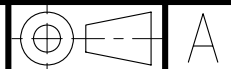

|  |             |                               |         |                          |             |                    |
|--|-------------|-------------------------------|---------|--------------------------|-------------|--------------------|
| ENGLISH / METRIC<br>ENGLISH                            | CHECKED BY  | B                             | 09JUL01 | SWB                      | DEV.        | GEN. REV. PER 1715 |
| TOLERANCES UNLESS OTHERWISE SPECIFIED                  | DRAWN BY    | A                             | 18FEB99 | MJG                      | DEV.        | GEN. REV. PER 0944 |
| MACHINED SURFACES TO BE 125 OR BETTER REMOVE ALL BURRS | ENGINEER    | II                            | 22MAY98 | MJG                      | DEV.        | INI. ISS. PER 0591 |
| ENGLISH (INCHES)                                       | METRIC (MM) | SCALE                         | APPLIC: | CERAMIC COAXIAL FILTER   |             |                    |
| .XX ±.02   | .X ±.25     | 4:1                           | DATE    | TITLE: 4BCR4C-1974/70-LX |             |                    |
| .XXX ±.010   | .XX ±.13    |                               | 22OCT01 |                          |             |                    |
| ANGLES ± 0° 30'  |             |                               |         |                          |             |                    |
|  | FINISH:     | BOARD: Sn63Pb37 PLATED COPPER |         |                          | DRAWING No. | SHEET OF 1 1       |
|  |             | JACKET: NI/SILVER             |         |                          | 0L0093      |                    |
|  |             | RESONATOR: SILVER             |         |                          |             |                    |